

OMNIA

Wi-Fi Smart Devices



Smart Wall Socket User Guide OKS-604S

Notes Before Installation

1. Wi-Fi Only support a 2.4GHz network (802.11 b/g/n).
2. Neutral wire Required.
3. Basic electrical wiring knowledge or experience required , or please consult a professional electrician.
4. Do not load more than the maximum power capacity of the device.
5. ON/OFF Button also can be used as reset button, long press to reset your smart socket to factory defaults. Only do this if you are sure you want to erase all your settings.

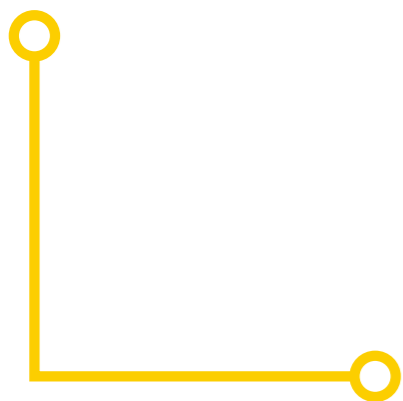

Specifications

Type	Smart Wall Socket
Model	OKS-604S
Power supply mode	Neutral+Live Wire
Rated Current	15A(Max)
Rated Voltage	AC110-125V~50/60Hz
Load Power	Single 1500W Total 2500W Inductive Load<2000W
USB Output	5V/2.1A
Wireless Frequency	2.4GHZ
Wireless Standard	IEEE802.11 b/g/n

Indicator light meaning

Indicator	Status	Description
Green	Rapidly blinks	Ready for connection (EZ Mode Only)
Green	Slowly blinks (1time every 3 S)	Ready for connection (AP Mode Only)
Red light is off	Off	Turn the power off
Red light is always on	On	Turn the power on
Green	Flash Slowly	No Internet



Safety Notice:

- Cut off the power before installation
- Please use it only when it's installed with RCD or current leakage protector at home

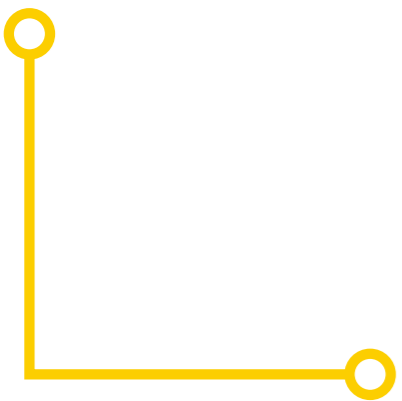
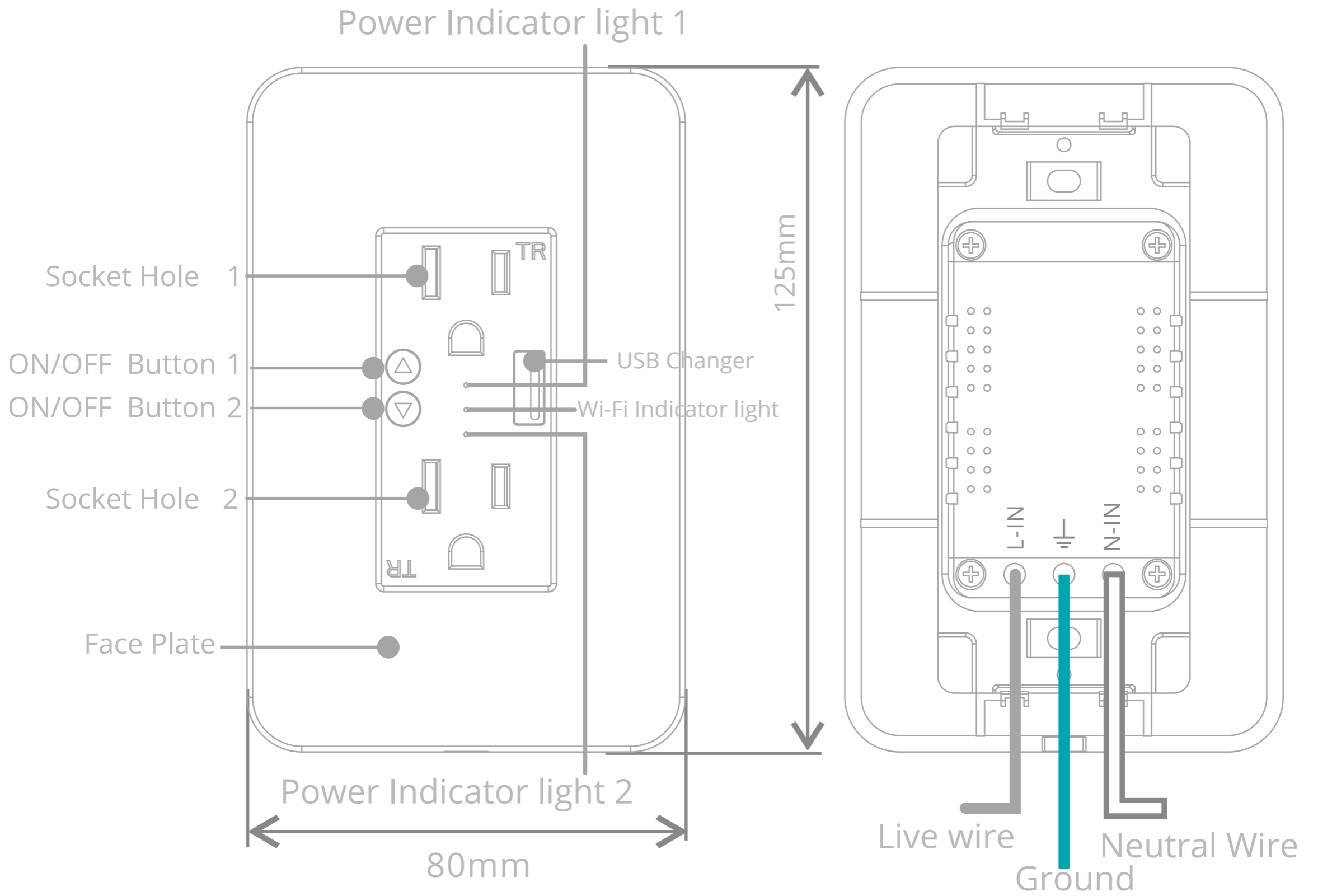

Installation Guide

STEP 1.

Turn off circuit breaker.
Find your socket's control in your circuit breaker and turn it off,

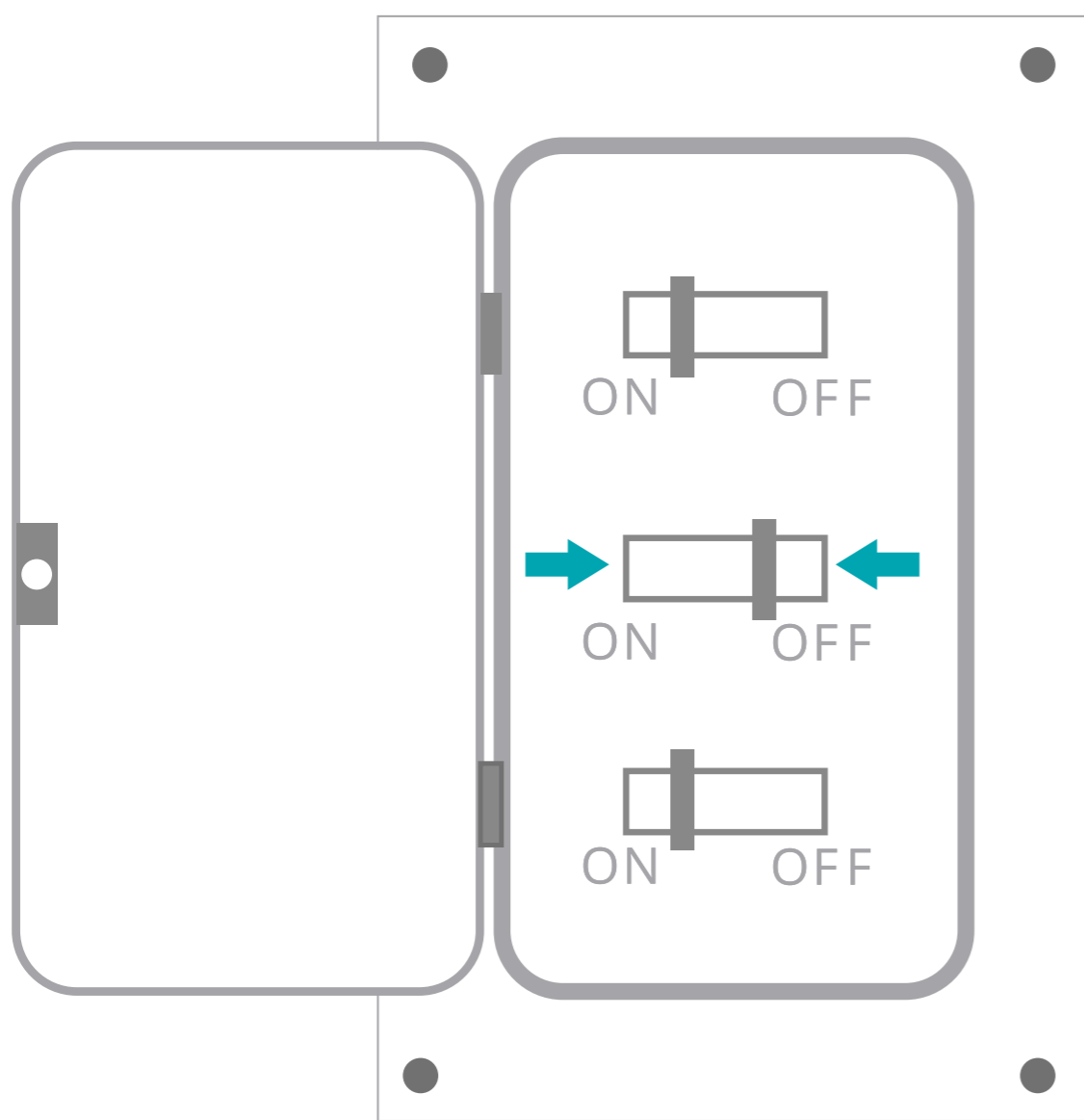

STEP 2.

Remove the original socket
In the wall cassette find the neutral wire, line wire and ground wire.

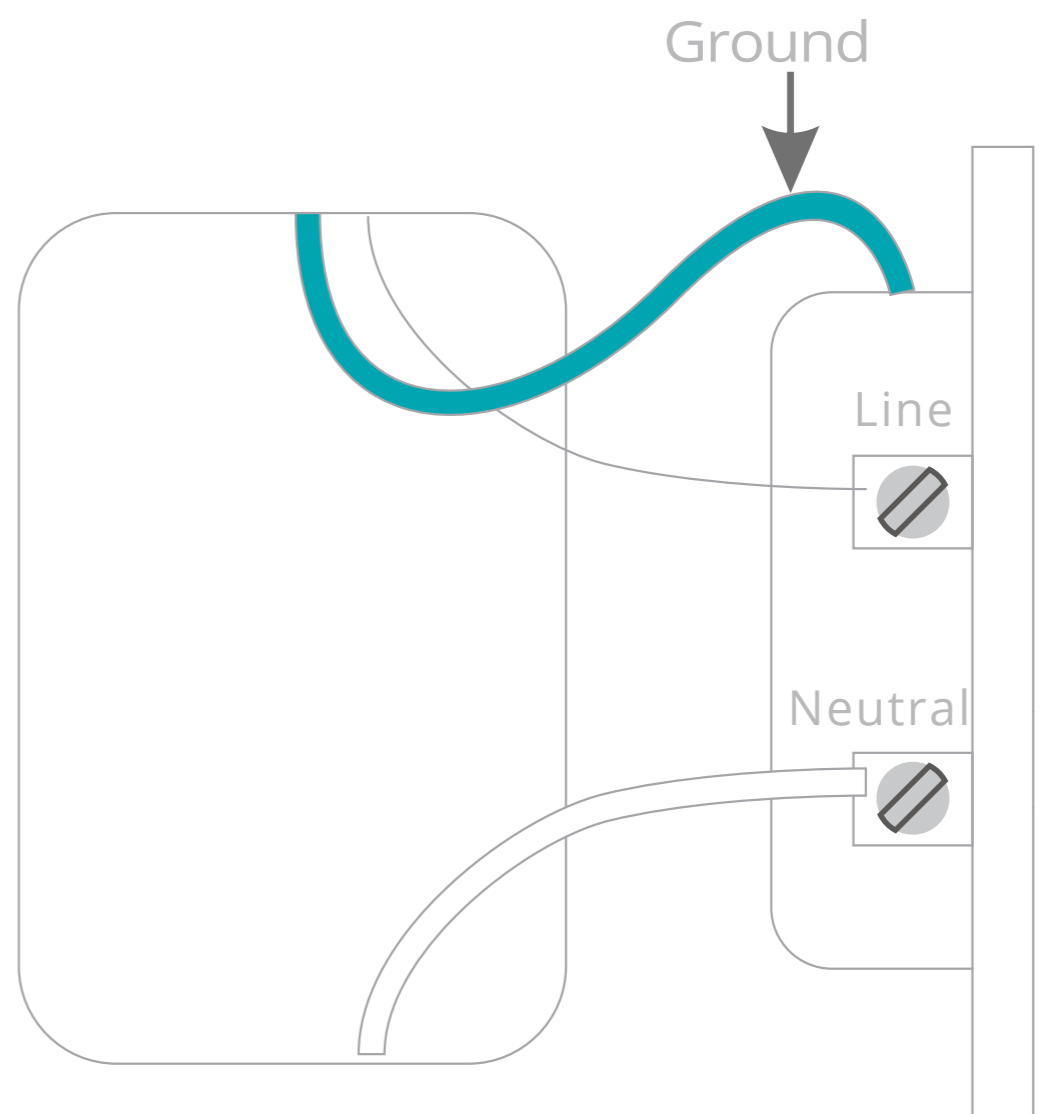

! If your original socket is also two jacks, you may find 4 or 5 wires. Please find the neutral wires, Line wires and ground wires. This smart socket only needs to use the neutral wires, Line wires and ground wires, other lines do not need to be connected

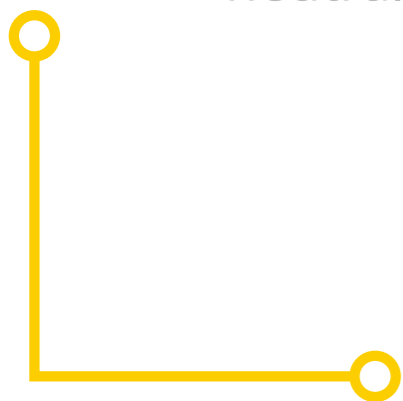

STEP 3.

Label your wires.

Mark or record the corresponding line before removing the old socket

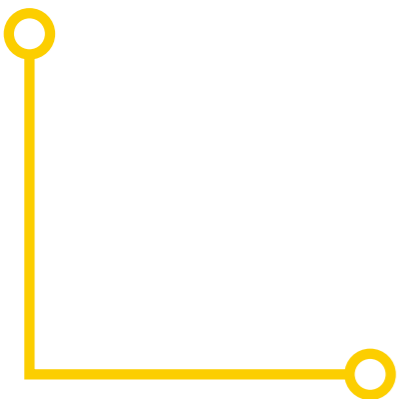
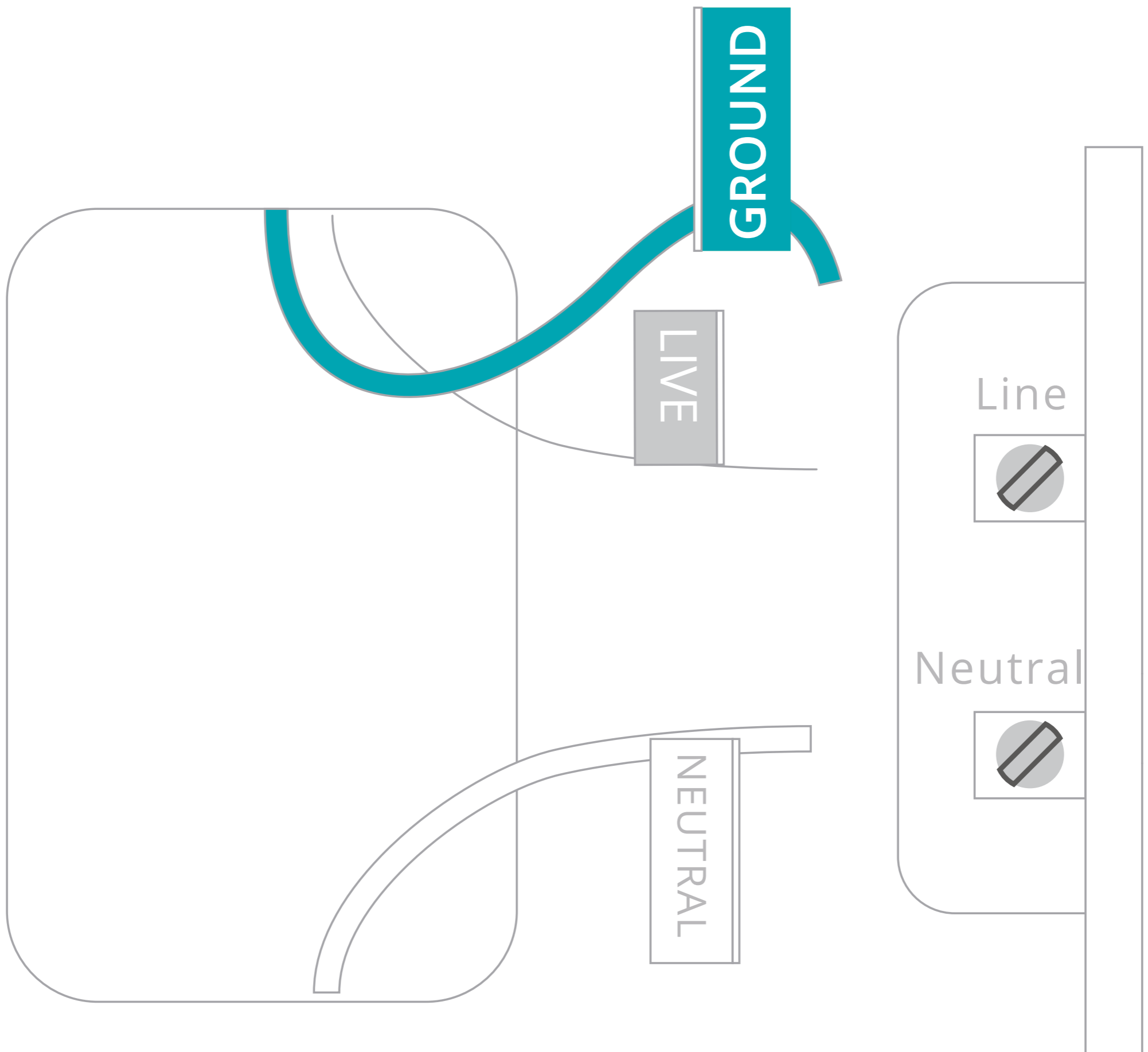

STEP 4.

Install socket

Use wire-nuts to connect the socket wires to your home wires, following the diagram. Be careful to match each line. Then remove the stickers, screw the socket into the wall, and attach the faceplate.

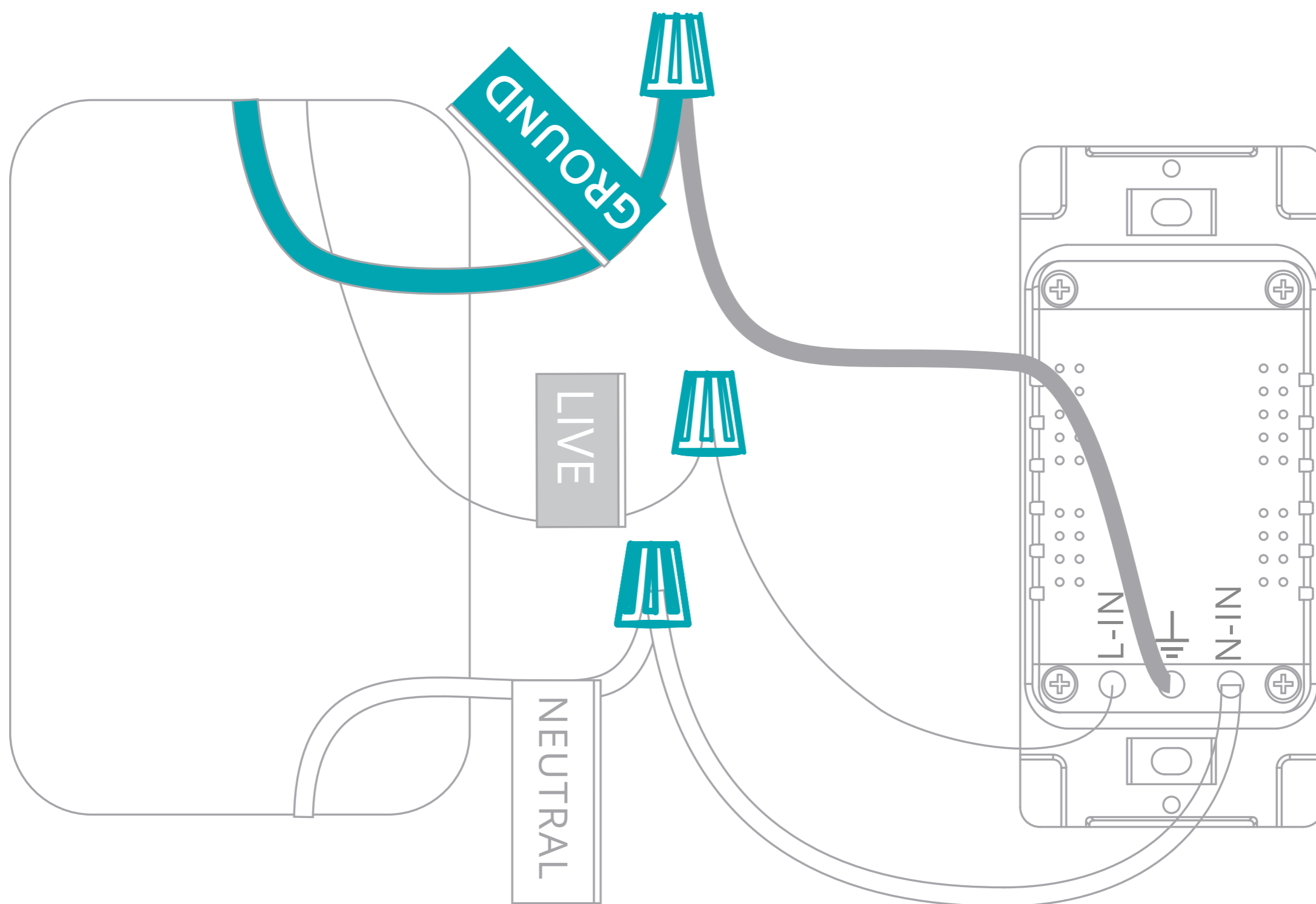

⚠ For safety, please connect the ground wire.

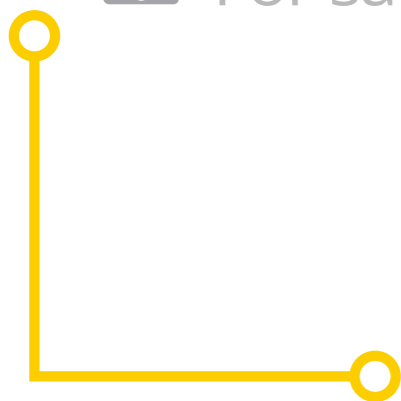

STEP 5.

Turn on circuit breaker
Turn on your socket's power from the circuit breaker.
Press the socket a few times to make sure it works.

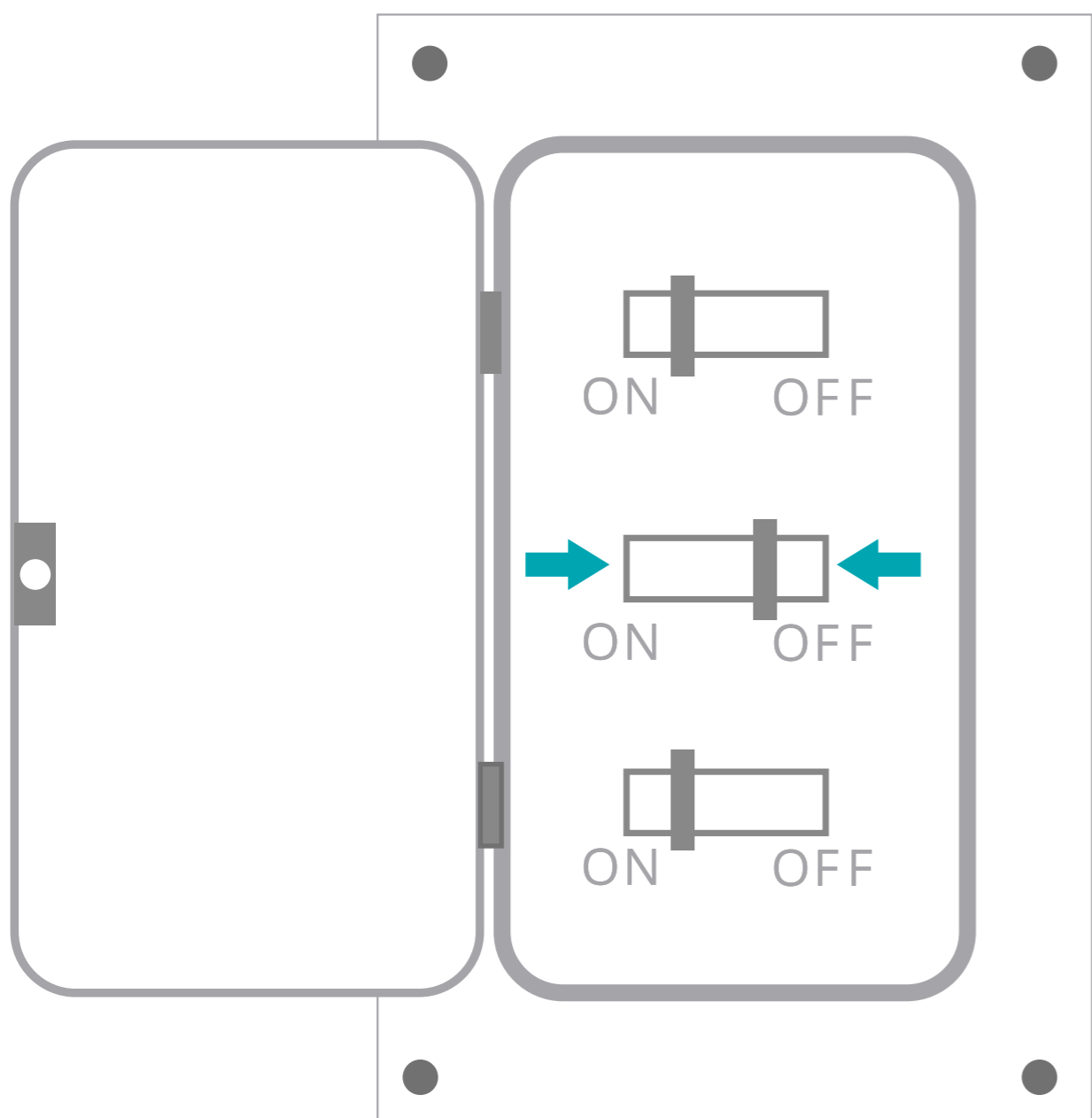

STEP 6.

Check the Wi-Fi light.
To start the pairing mode, press one of the buttons until the WiFi indicator light blinks. Select Next on the APP to continue.

Indicator light rapidly blinks
(2 times per second).

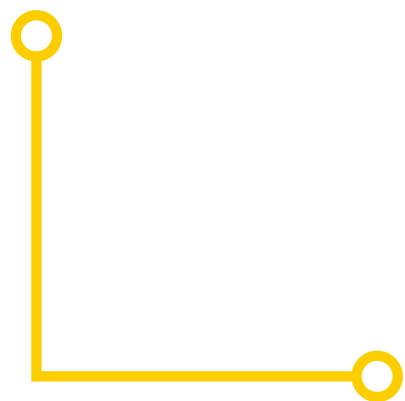
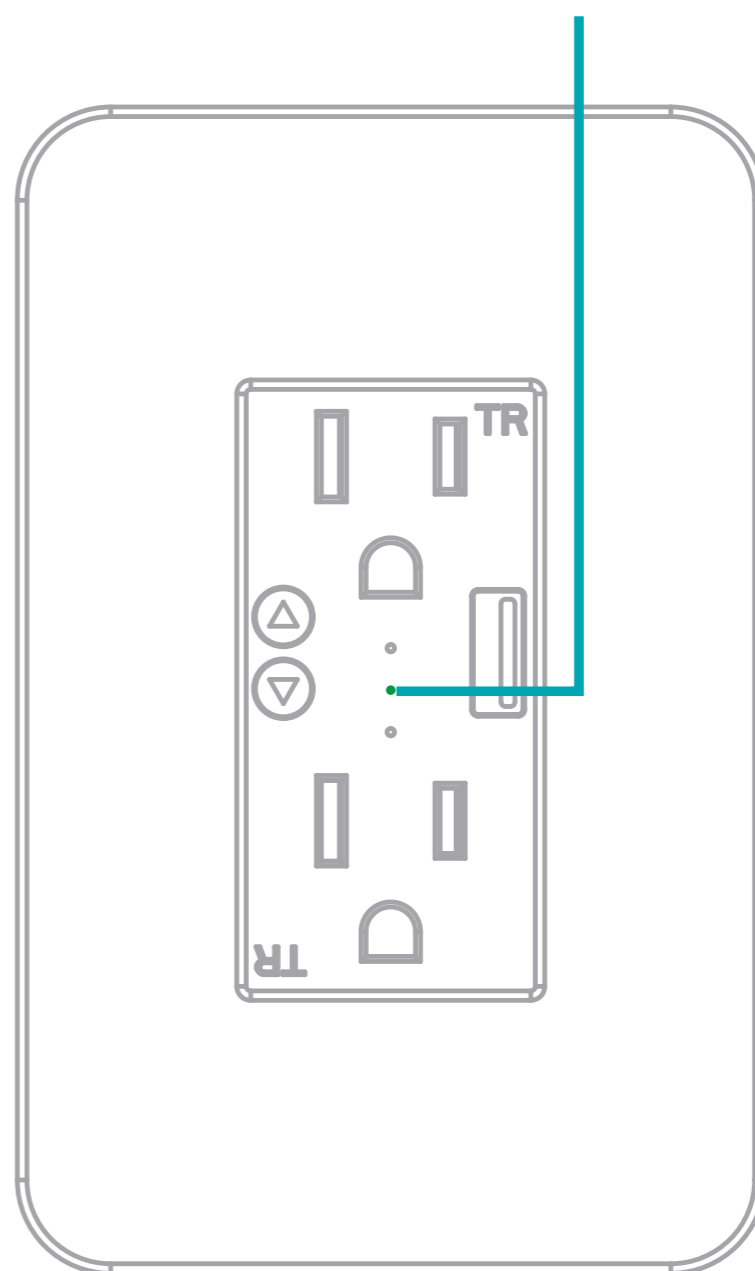

Install the “Smart Life”APP

Step A. Search “Smart Life”app in Apple app store, Google Play, or scan the QR code bellow and install it.



The free app “Smart Life” is compatible with mobile devices the support IOS8.0 above, Android 4.4 above.

Step B. Enter the register interface, input the email address/phone number for getting the verification code to register an account or just login if you already have a Smart Life account.

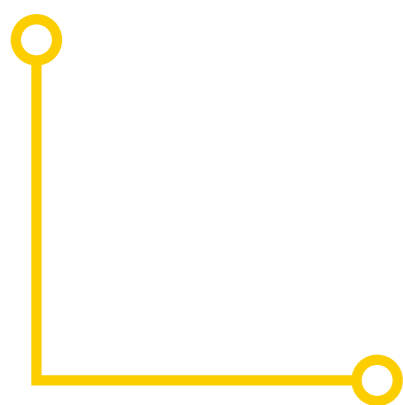

Step C. Add the switch to Smart Life APP

Note: This smart socket can only support 2.4G network and cannot work with 5.0G network. please check if your home network is 2.4G and make sure that your phone has been connected to your WI-FI home network.

(1) Tap "+" button on top right corner to add device, then tap "Electrical Outlet" to enter next page.

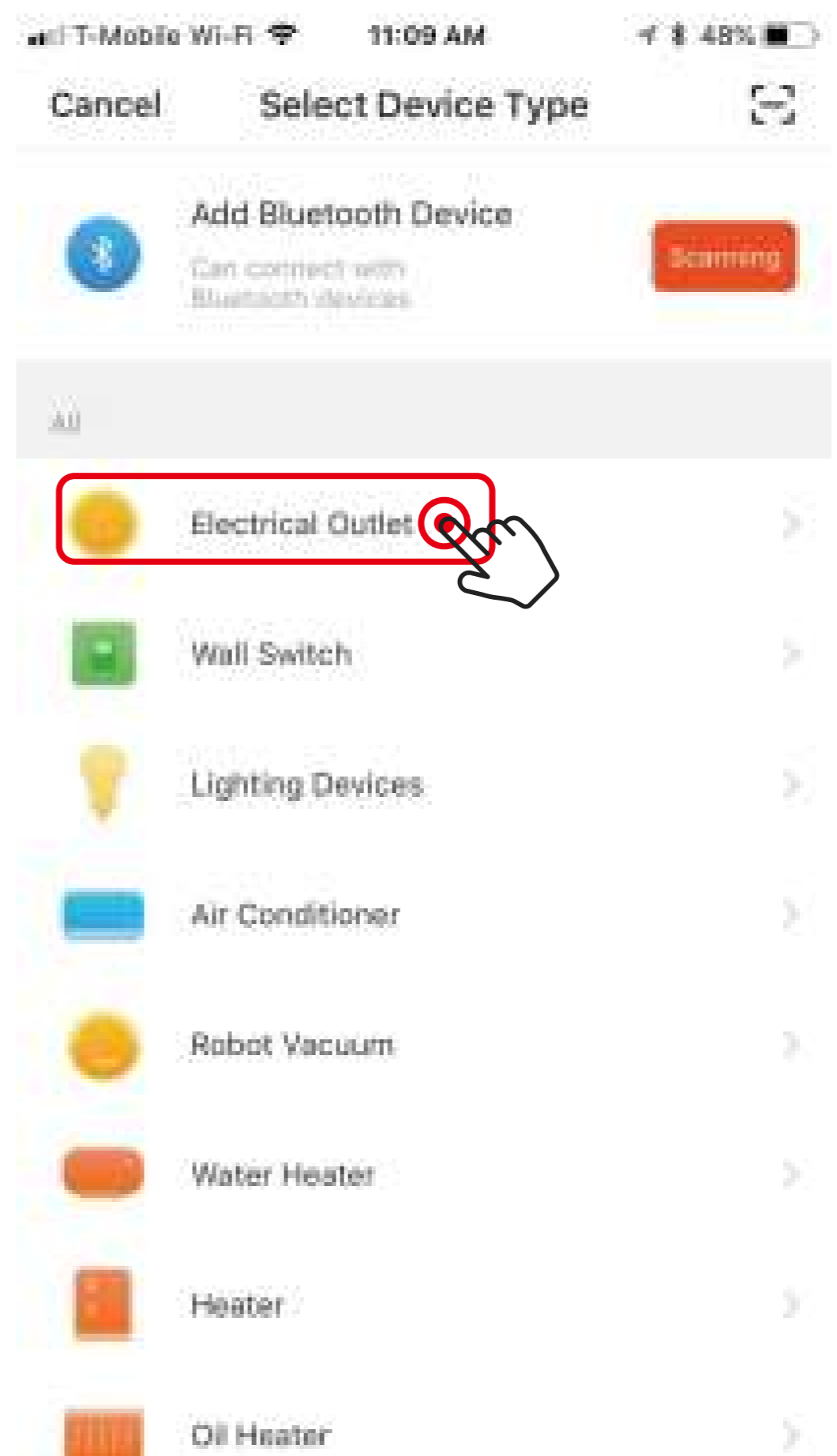
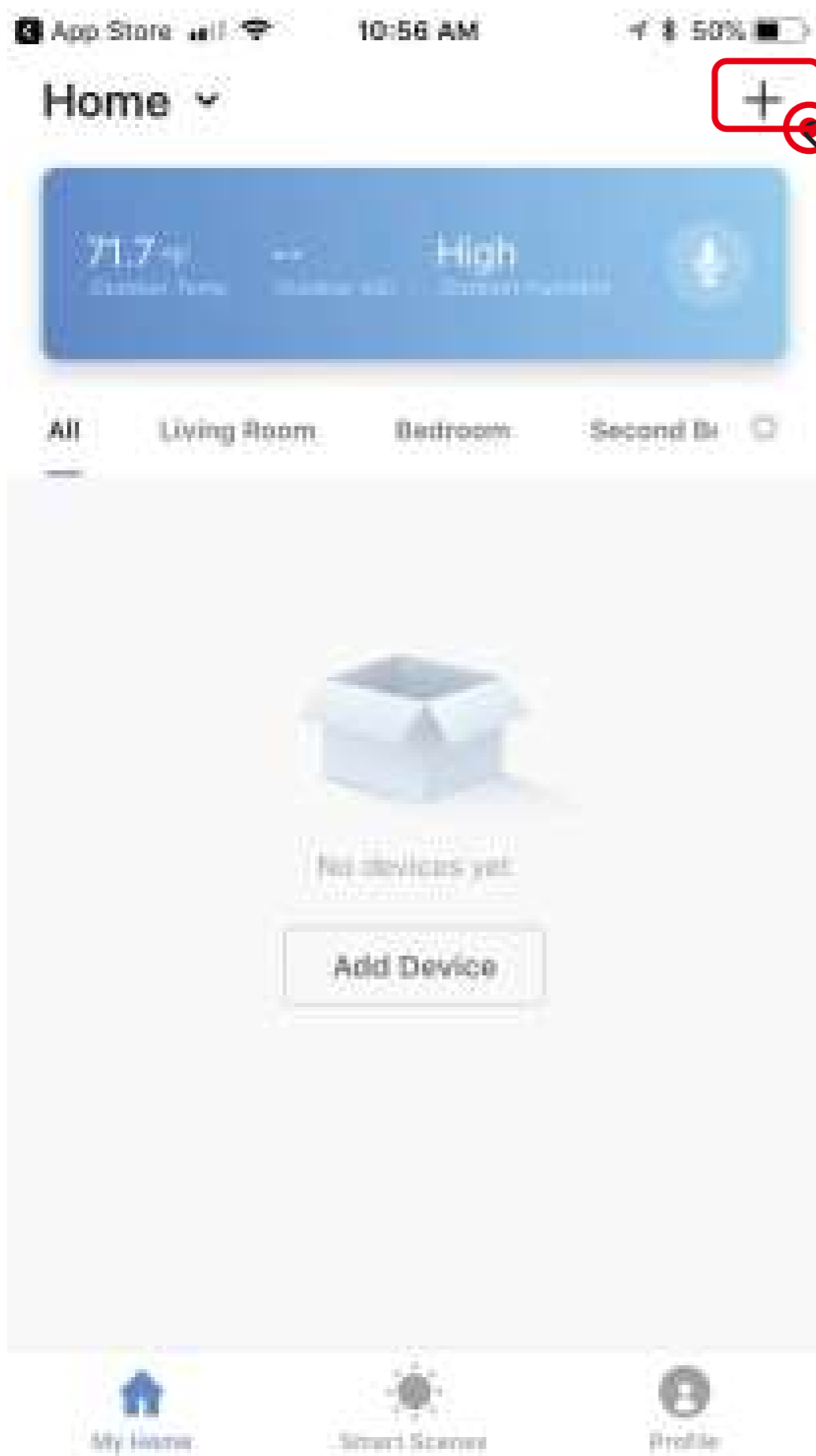

EZ Default Mode(Recommend)

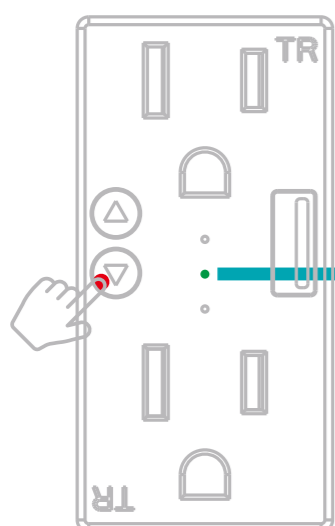

Indicator light rapidly blinks (2 times per second).

Step 1. Make sure the indicator blinks rapidly, if not, hold any of the ON/OFF buttons for 7 seconds to enter on pairing mode.

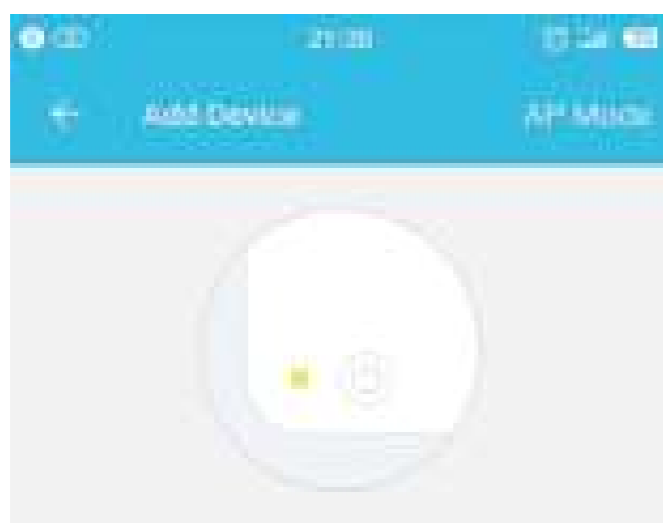

Power on the device and confirm that indicator light rapidly blinks

[How to make indicator rapidly blink](#)

Confirm indicator rapidly blink

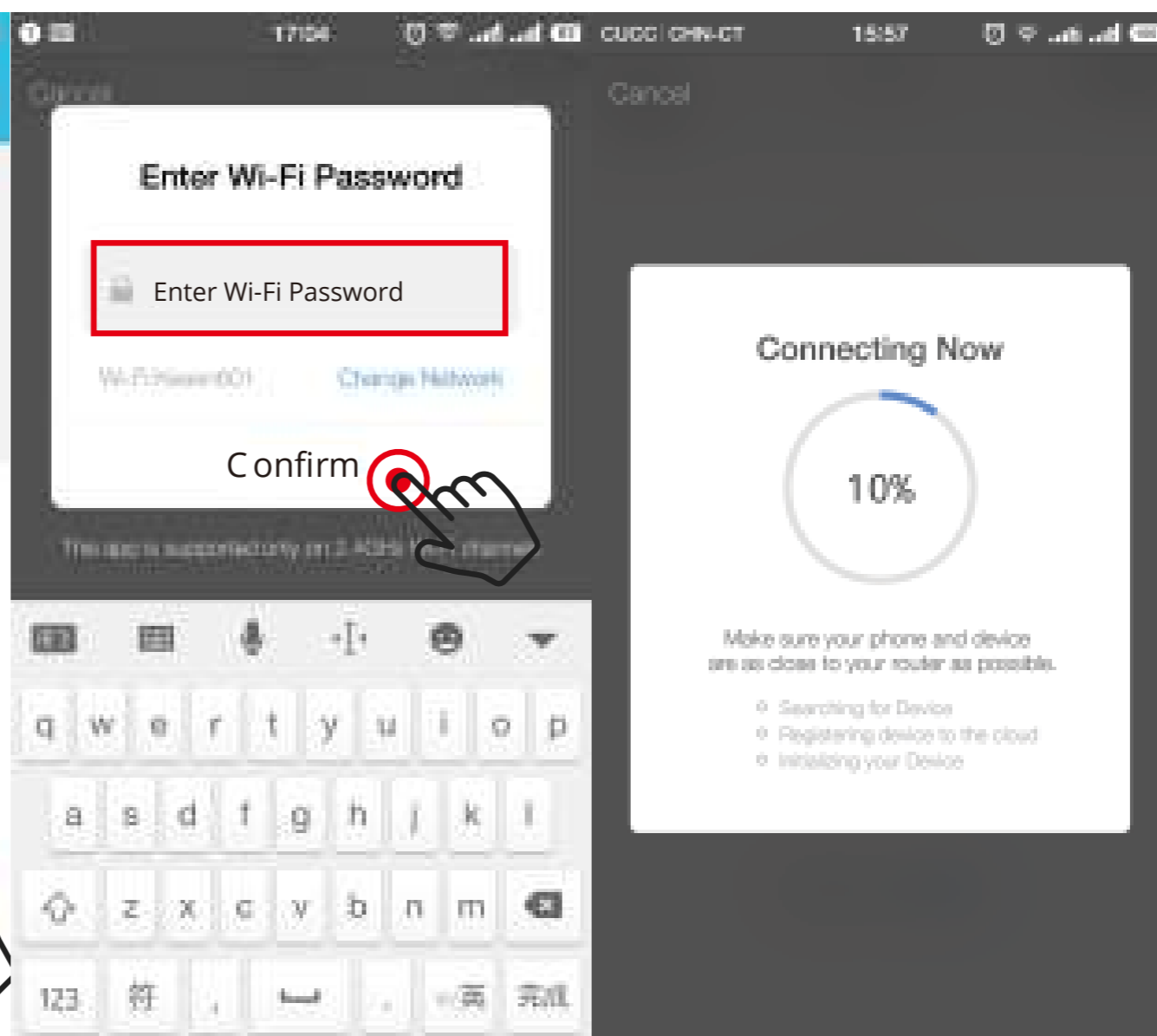

Step.2.Power on the device and confirm

Step.3.Enter Wi-Fi password to join your network

Step.4.Wait until it is successfully connected.

Note: When finished the default mode please go directly to Step 9.

AP Mode(Alternative)

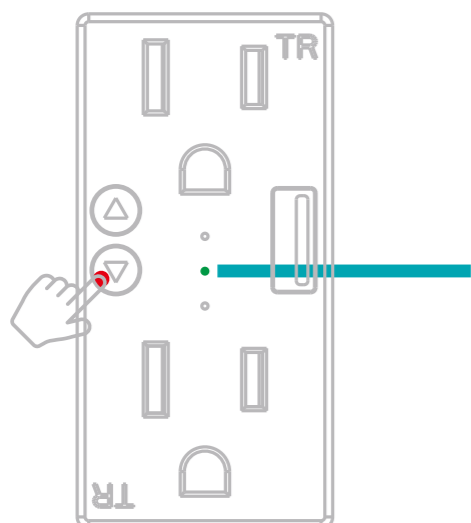

Indicator light slowly blinks
(1 time every 3 second).

Step 1. When the indicator blinks rapidly, press and hold any of the ON/OFF buttons for another 7 seconds. the indicator will blinks slowly.

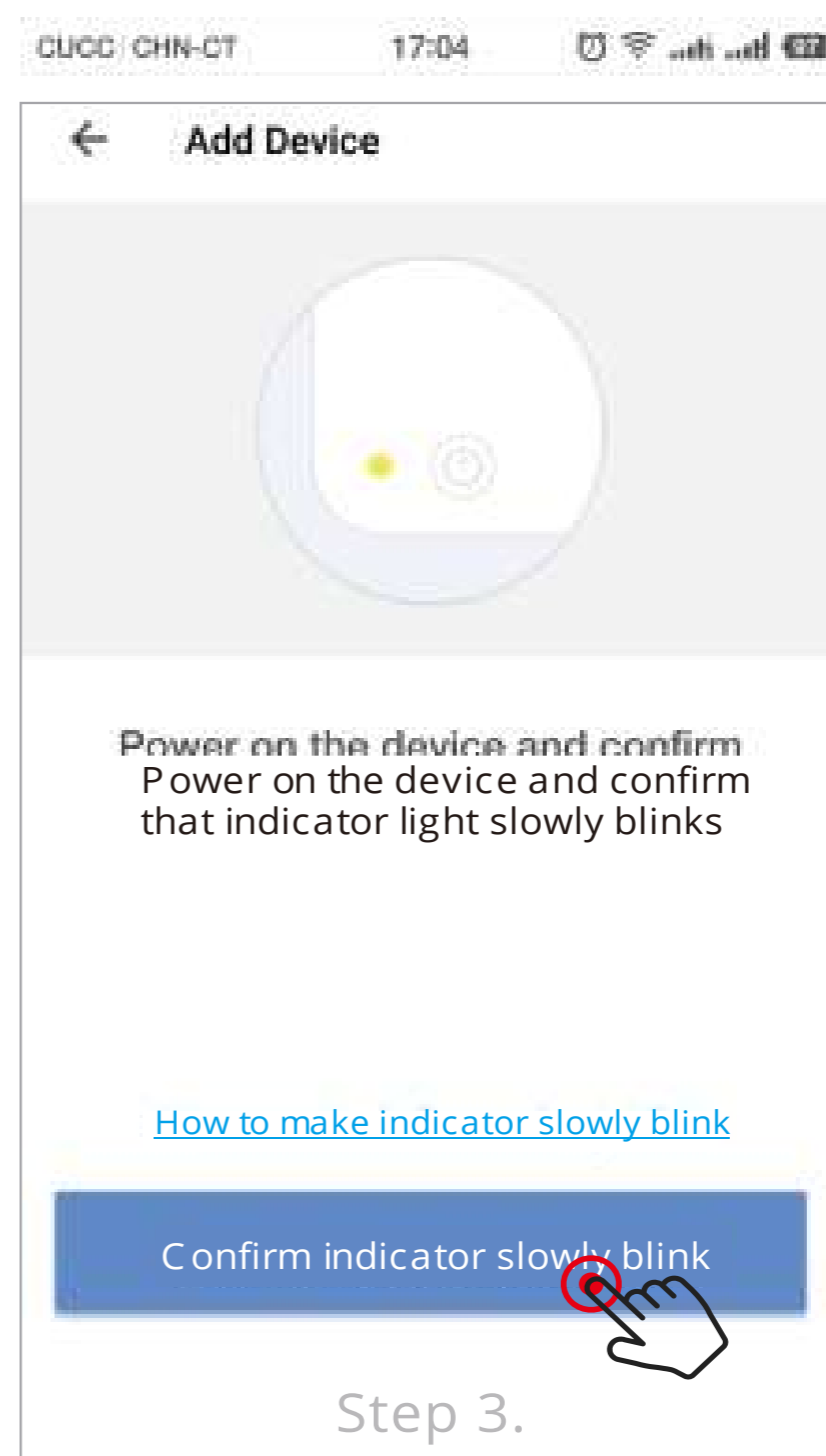
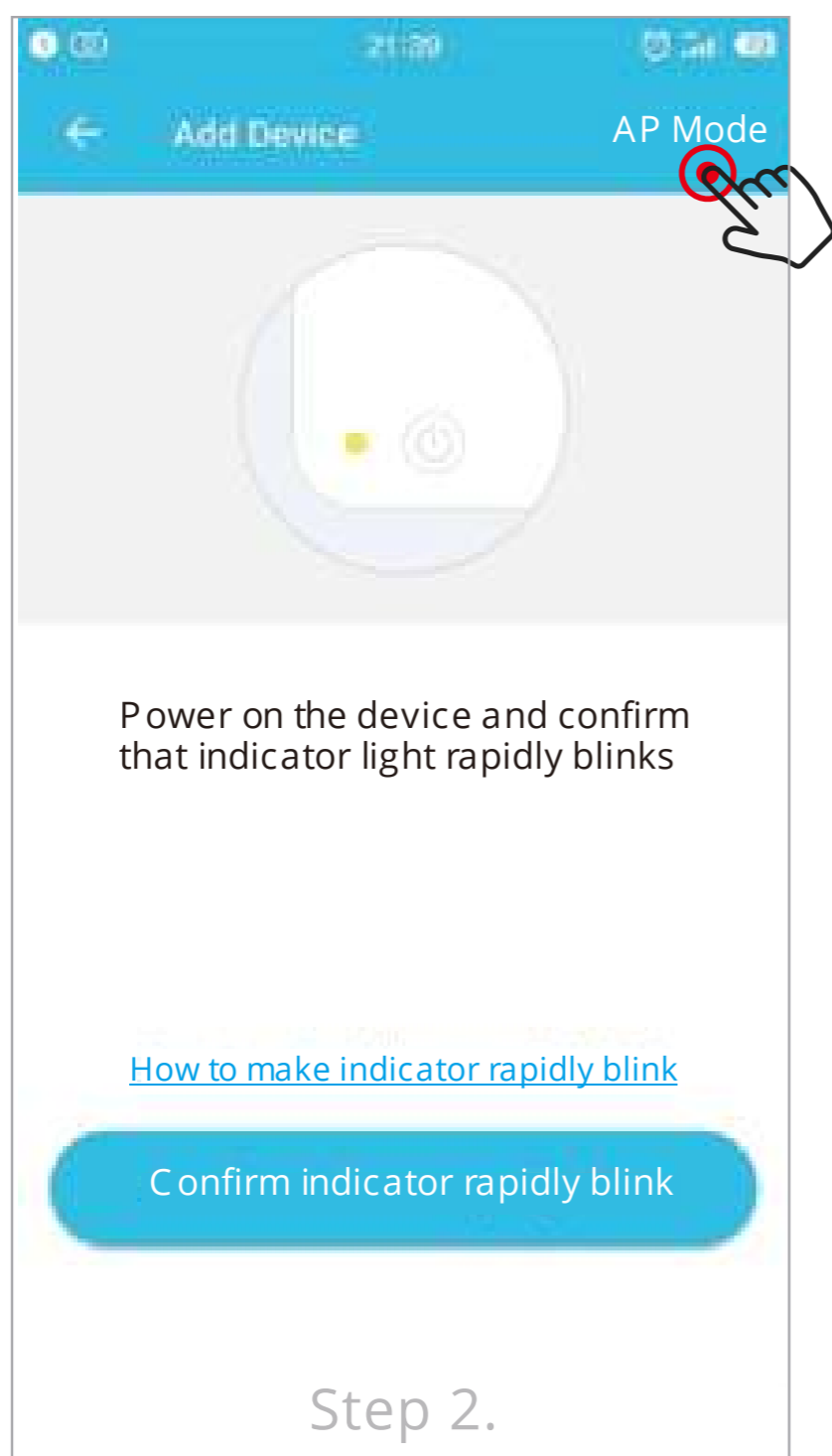

AP Mode steps continued.

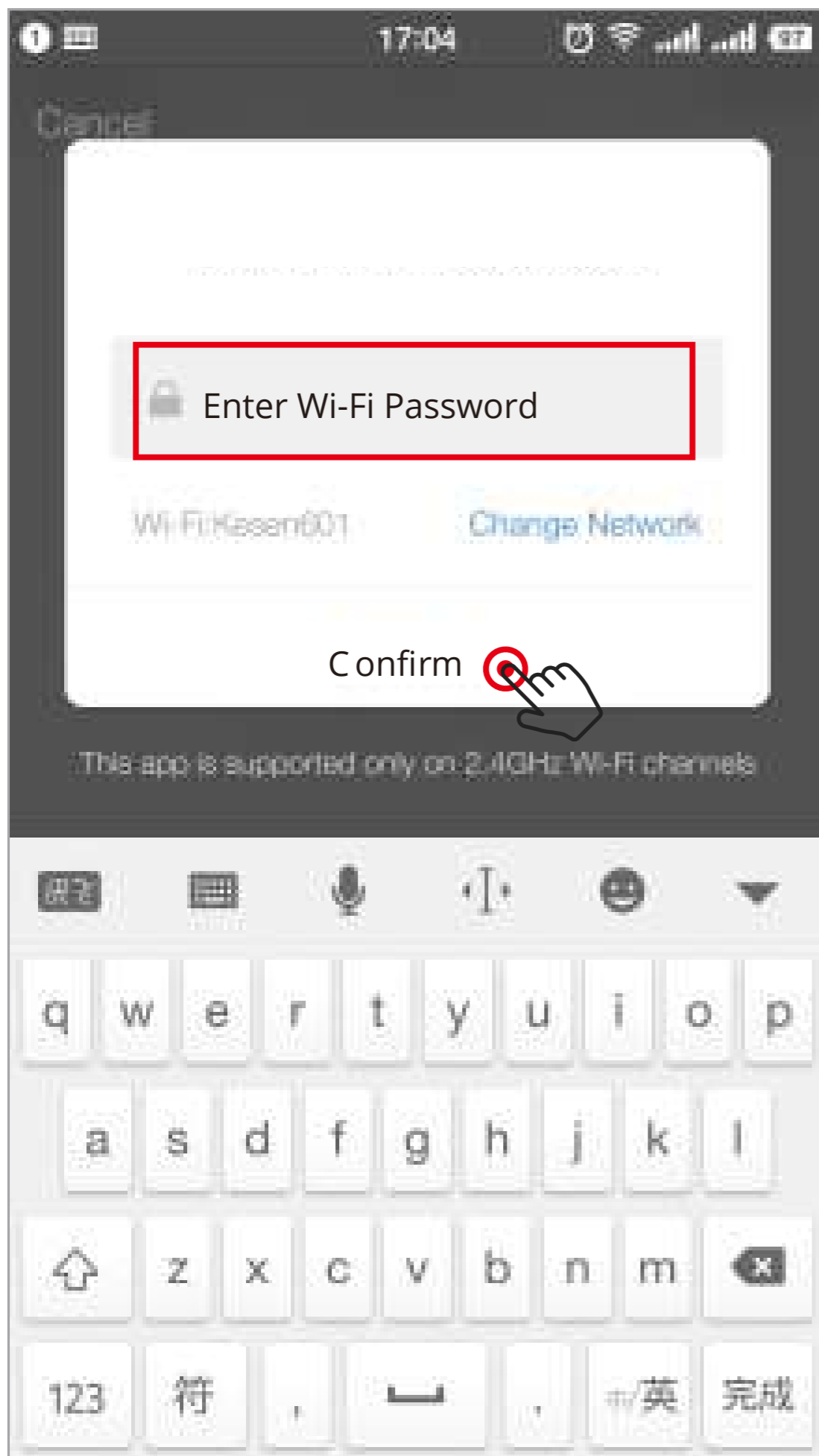

Step 4.



Step 5.

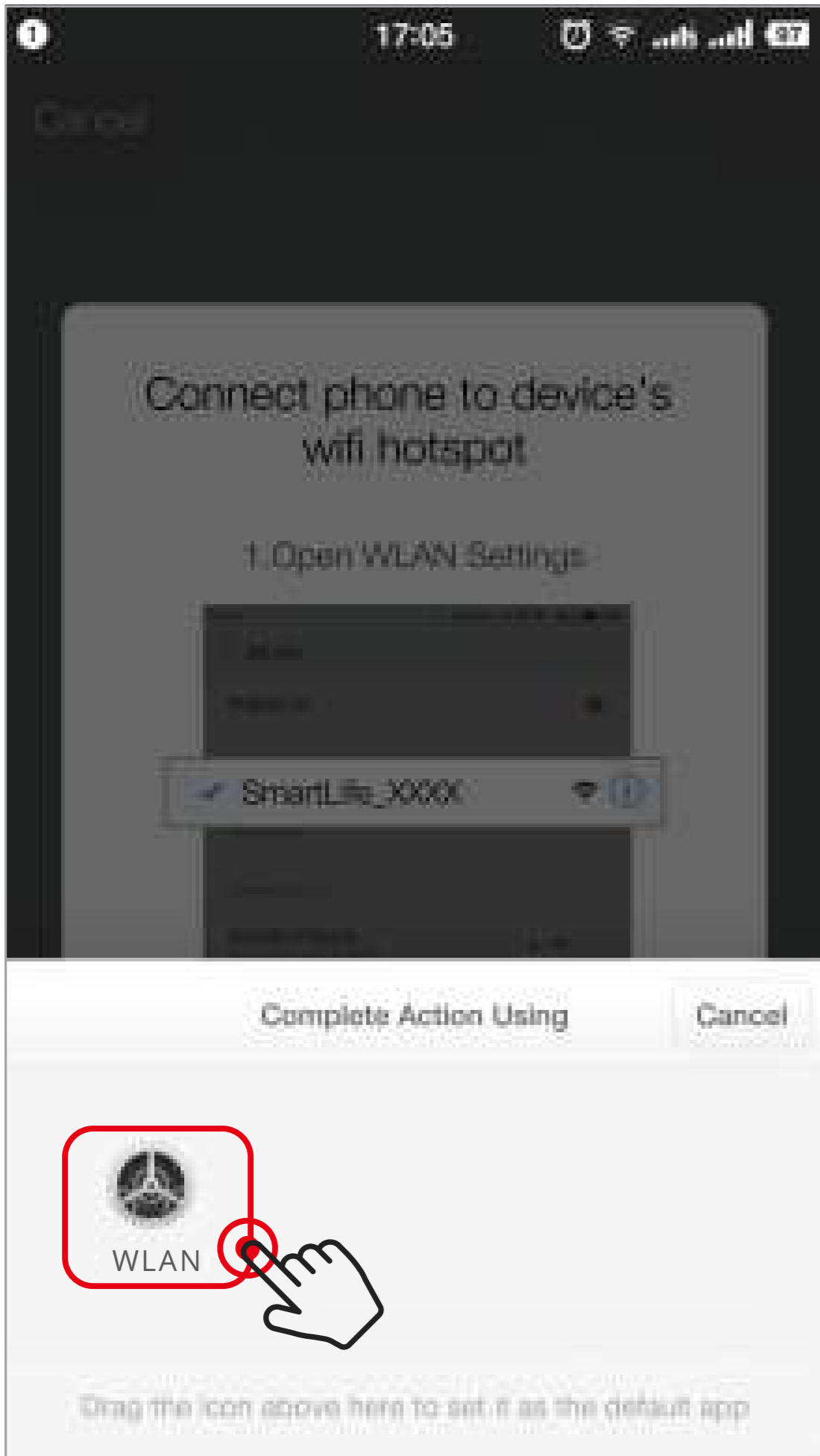

Step 6.

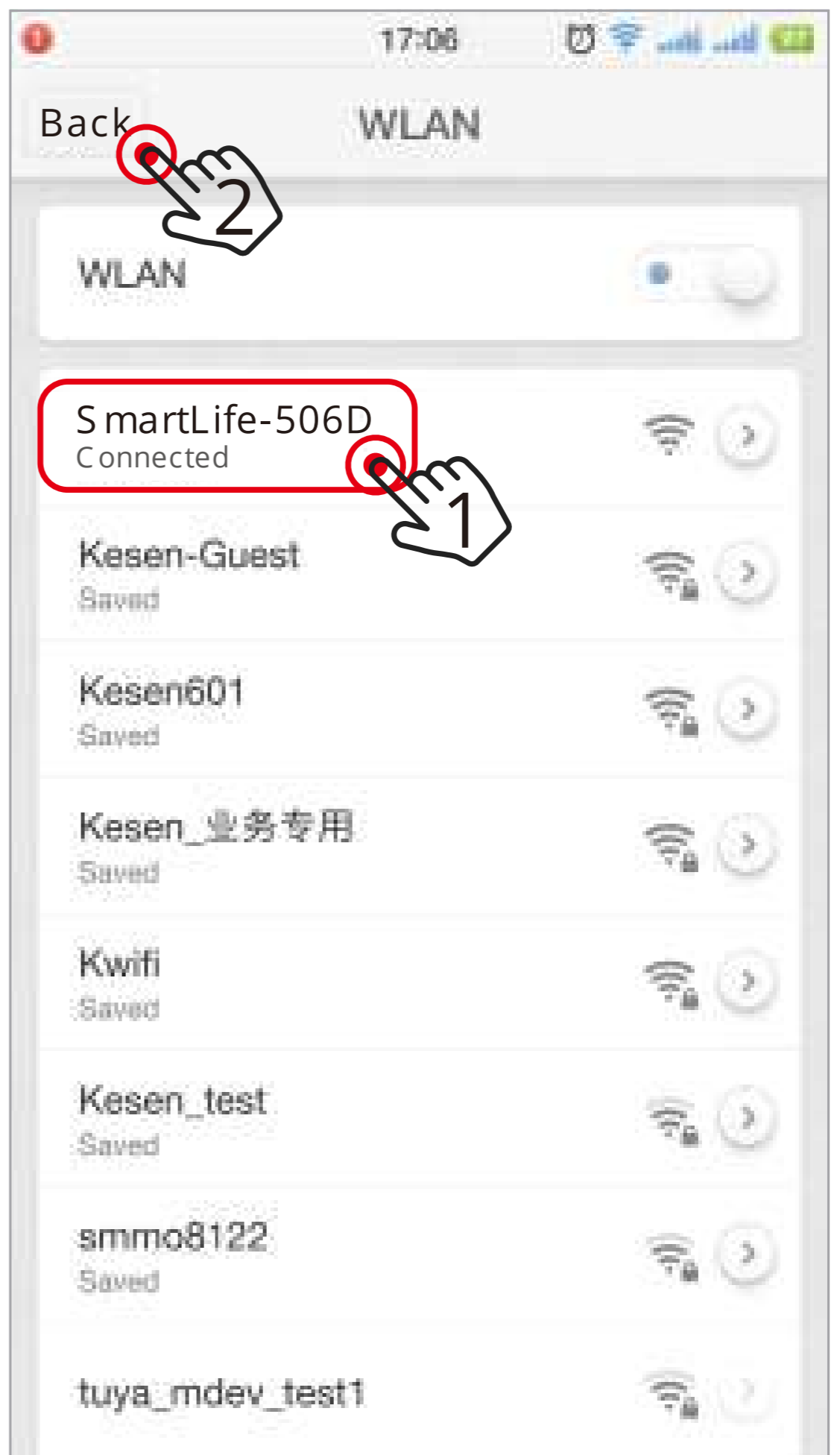

Step 7.

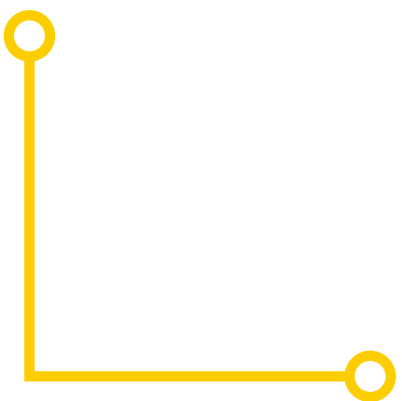

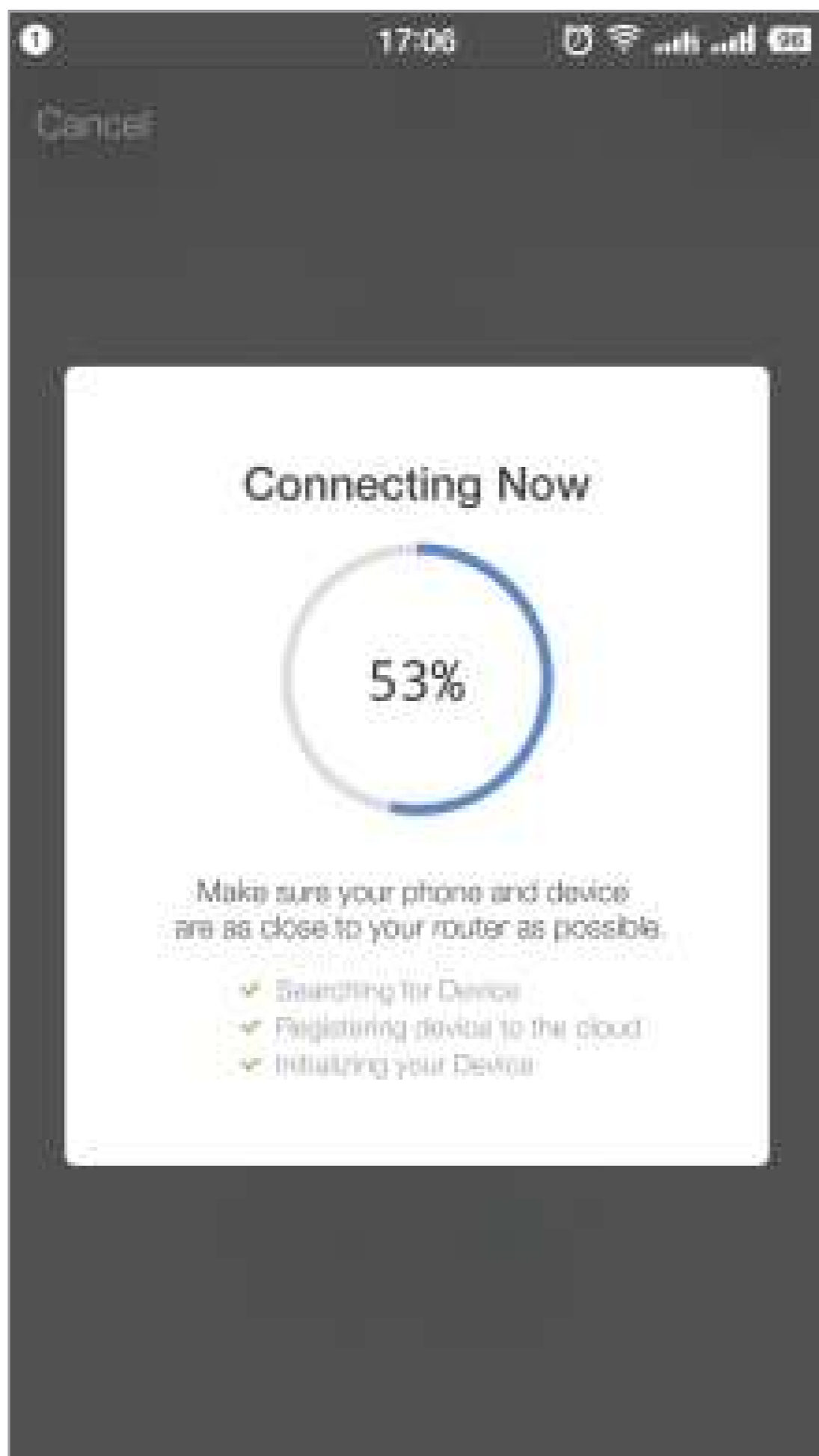

Step 8.



Step 9.
Modify socket name

Step D: Give a name to the socket and tap "Done". You will find the device you've named is shown on the app homepage. Tap the device to enter the setting page.

Note: The name you give to the device will be the name for voice control on Amazon Alexa or Google Home later. For example, the device is named "Socket" in this user guide.

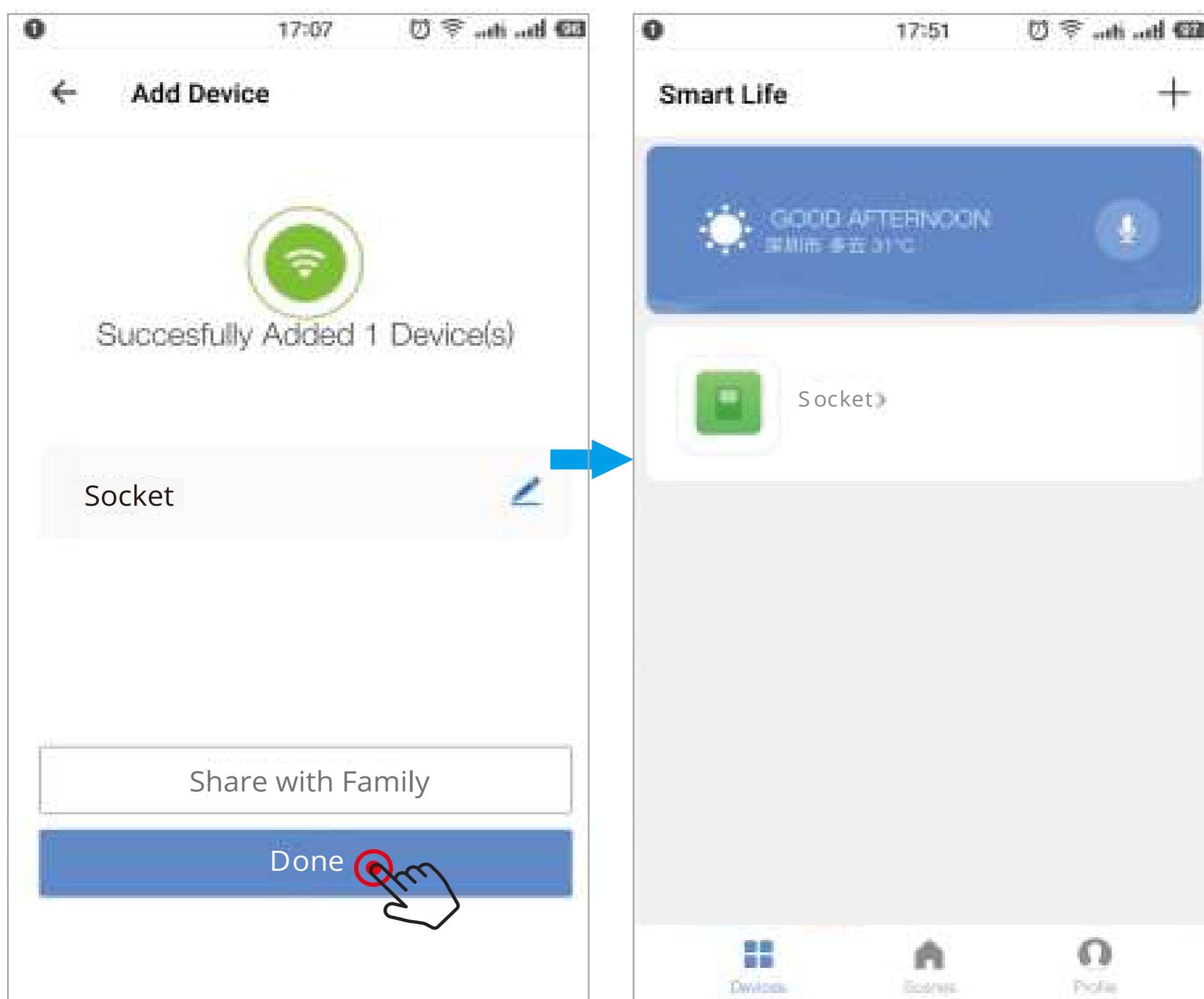

After completing install you can control the socket with Smart Life APP on this setting page.

Note: Both socket holes can be controlled separately, long press the name to rename as desired.

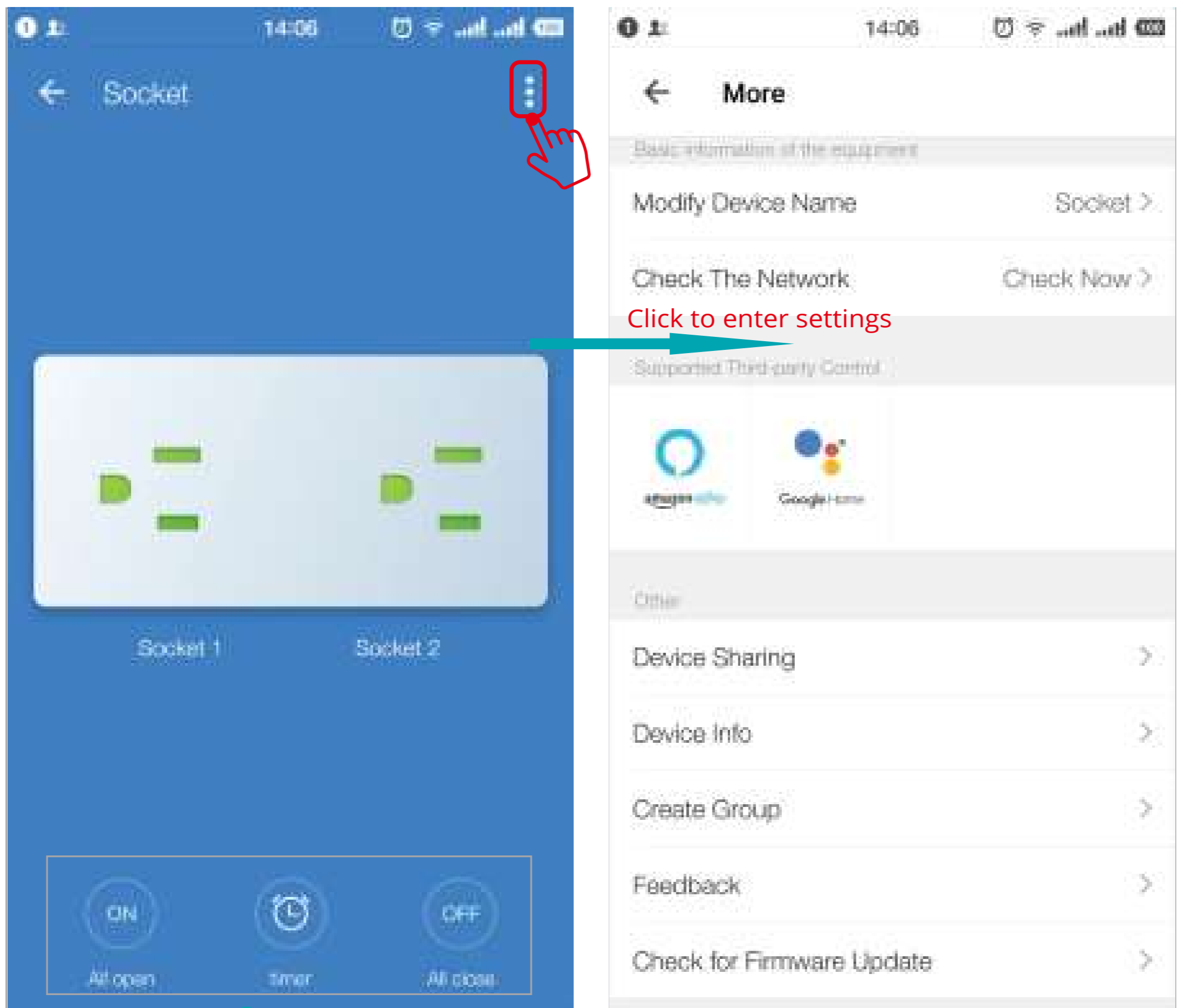

Try on/off and timer functions on the app to control the socket.

Try timer function to easily set up schedule to turn on/off smart socket.

Note: Both socket holes can be individually timed.

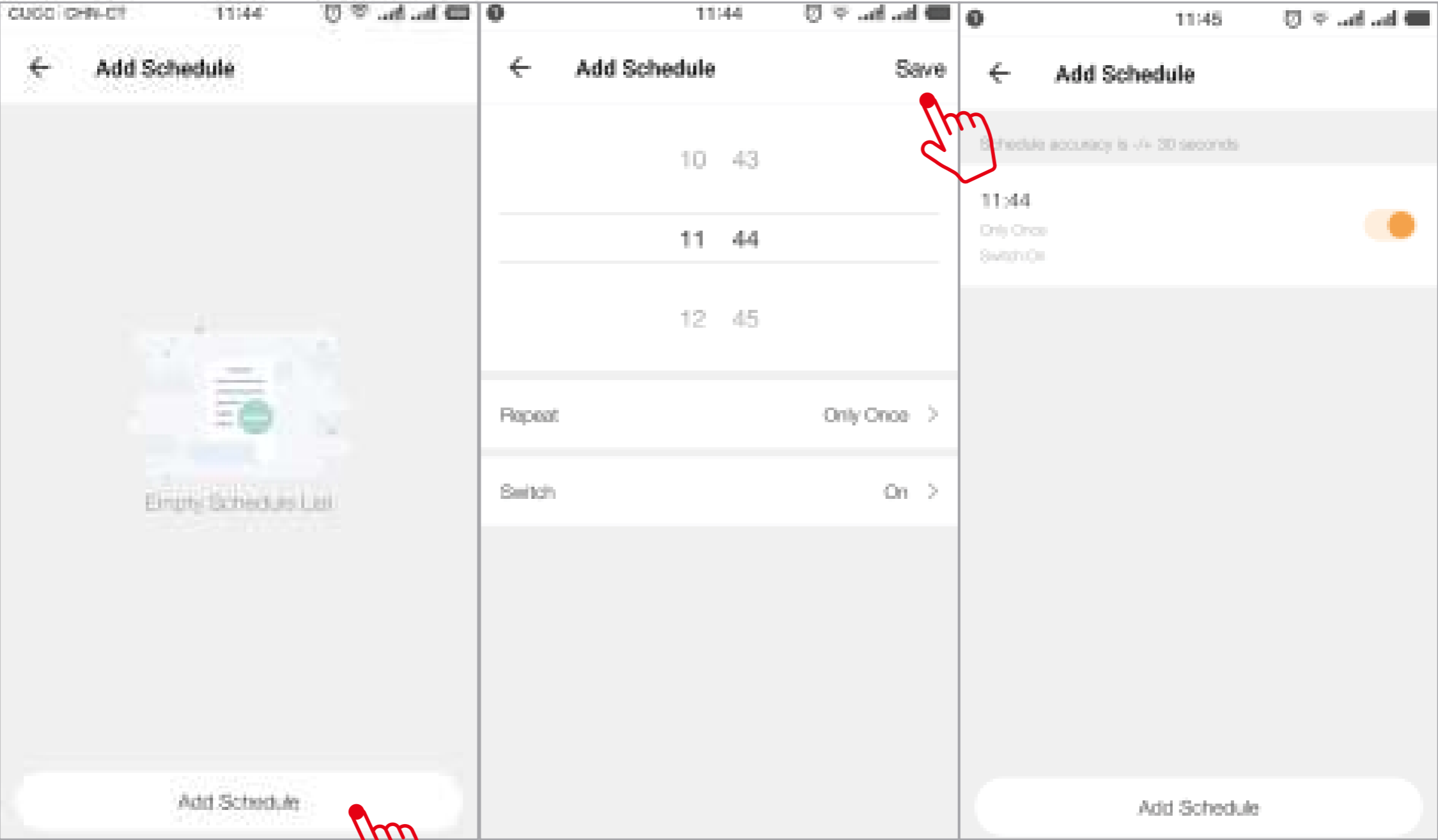

Note:

If you want to control the light with Amazon Alexa, please continue to read Page 10.

If you want to control the light with Google Home, please skip Page 10 and read Page 13 directly.

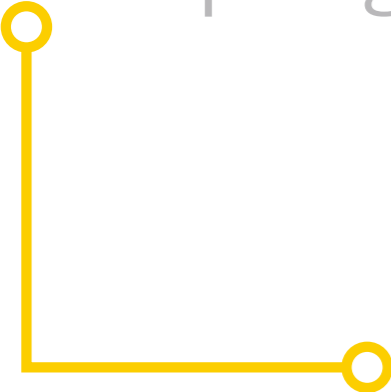

How to control the switch with Amazon Alexa?



Please make sure that your Alexa APP is connected to Amazon Echo and both work together successfully under your Wi-Fi home network.

Step A: Log in your Alexa APP, tap top left corner, and tap "Skills".

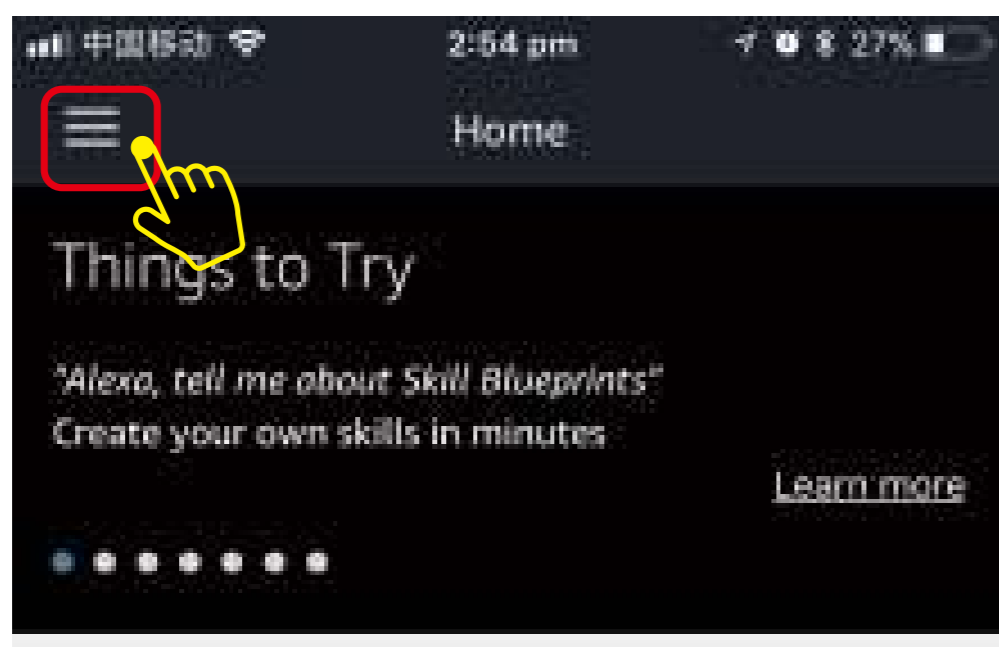

Your Alexa settings have been updated

Household Drop In was enabled from one of your Echo devices or from the Alexa app. The opt-in Drop In feature lets you automatically connect to an Echo device for a voice or a video chat. Your Echo devices with a screen and the Alexa app will indicate which of your other devices are recently active.

[ALEXA TERMS OF USE](#)

More ▾

Welcome!

Amazon is excited to bring you Alexa on Jas's Echo

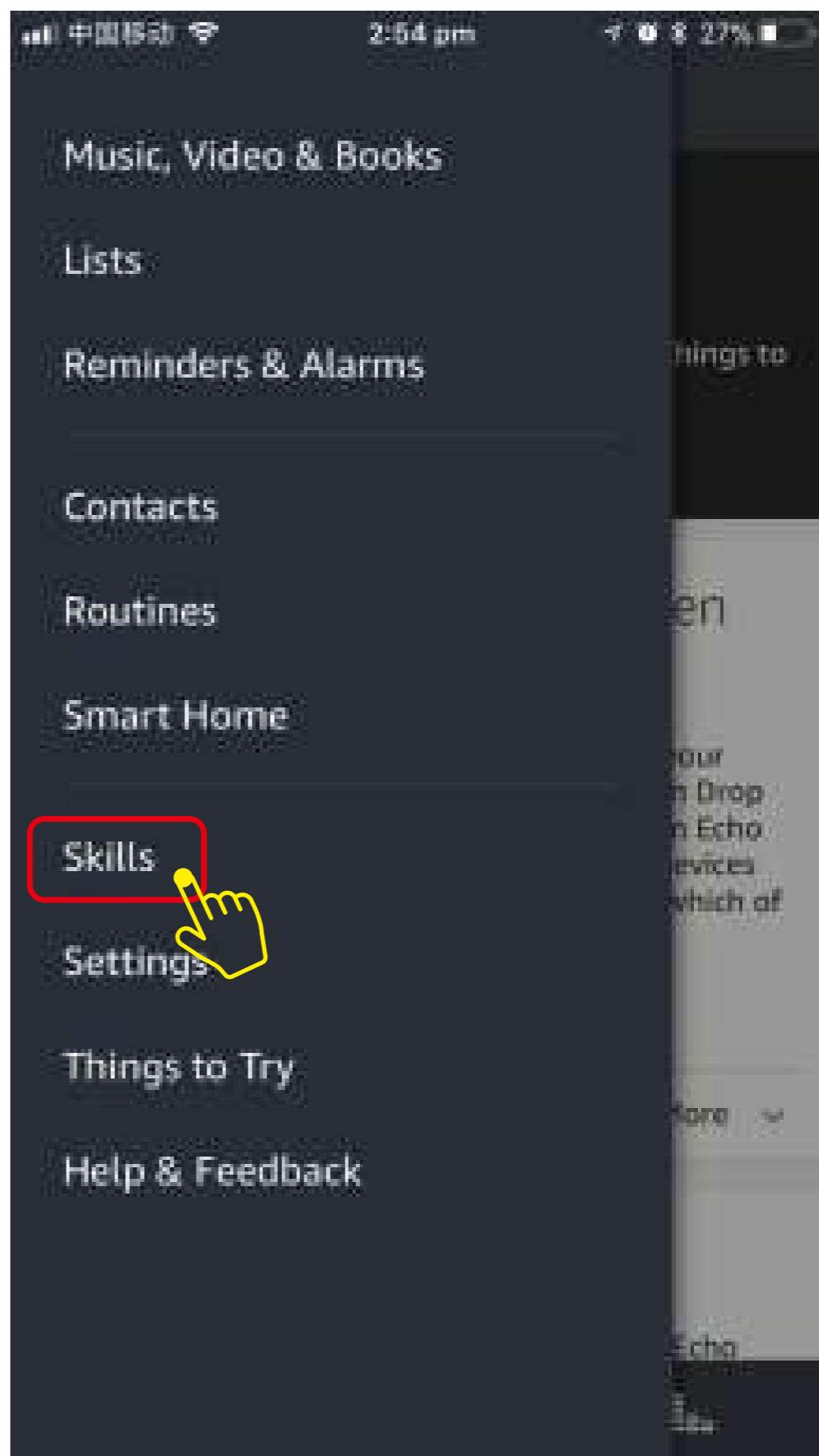

Step B: Type "Smart Life", find "Smart Life" from the search result and tap it to enable the skill.

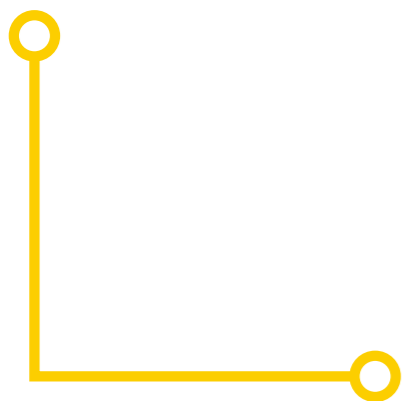
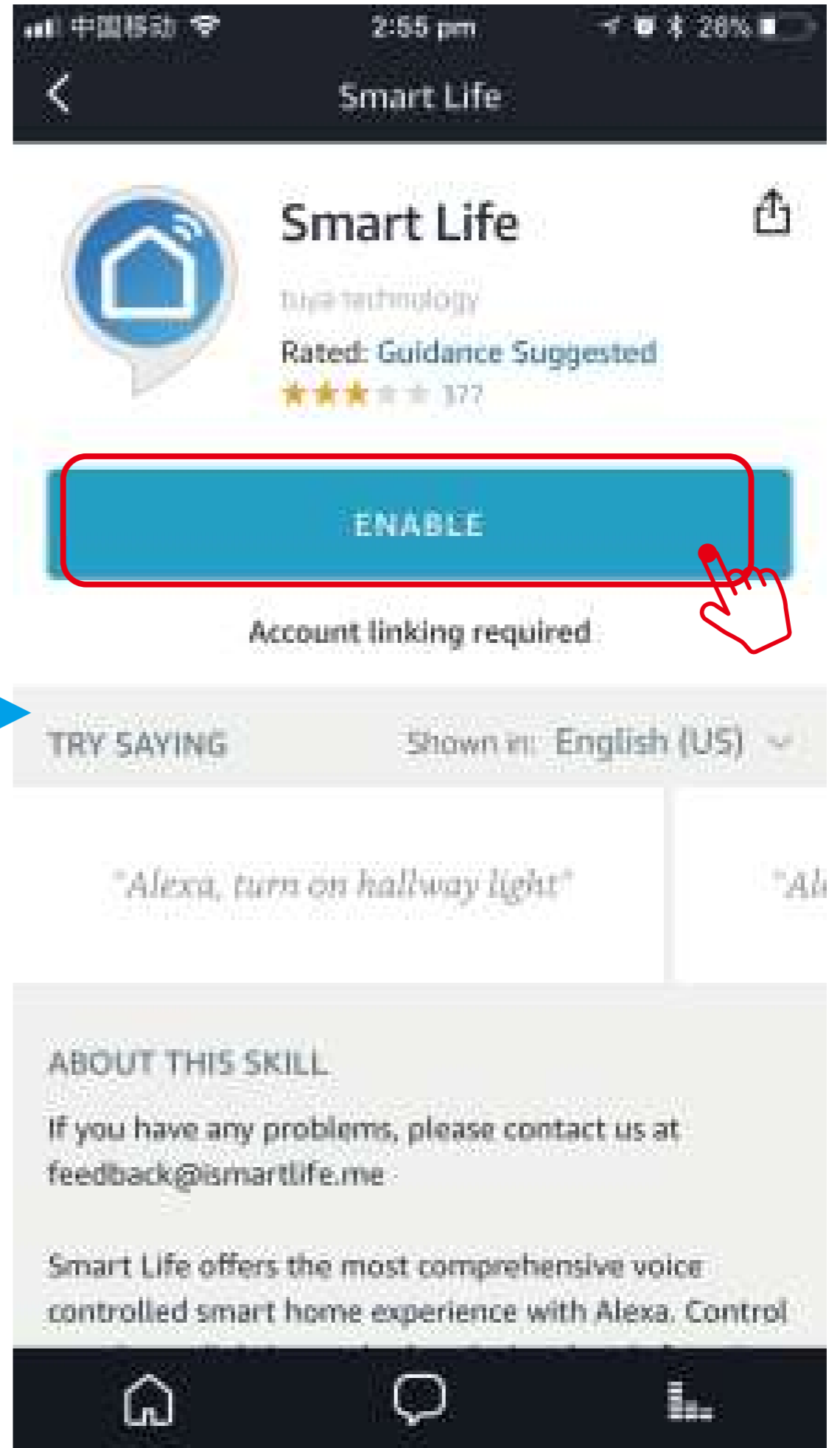
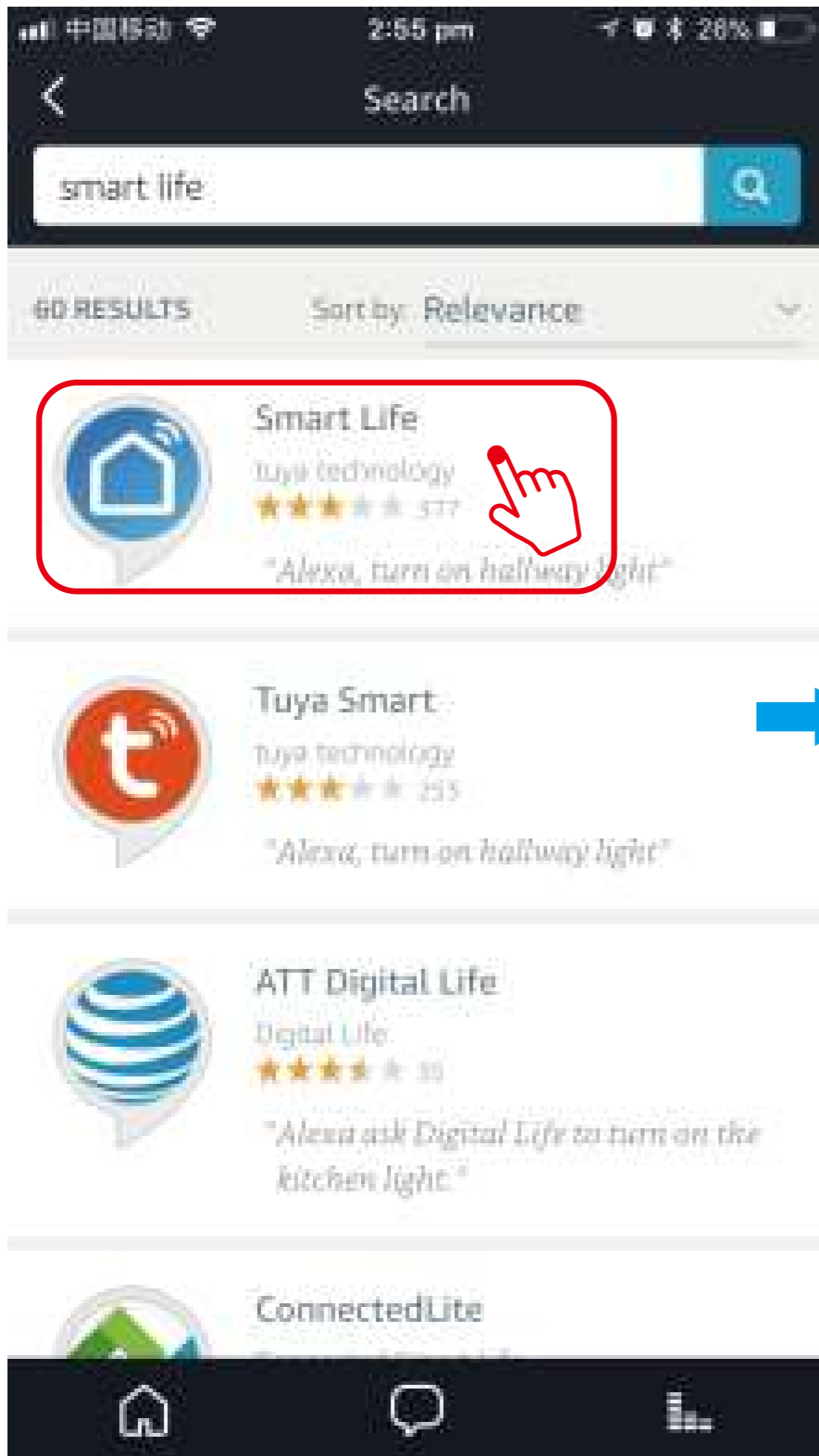

Step C: Enter your account and password of “Smart Life” app, tap “Link now”. Then tap “Authorize” on the next page to bind Smart Life account to Alexa.

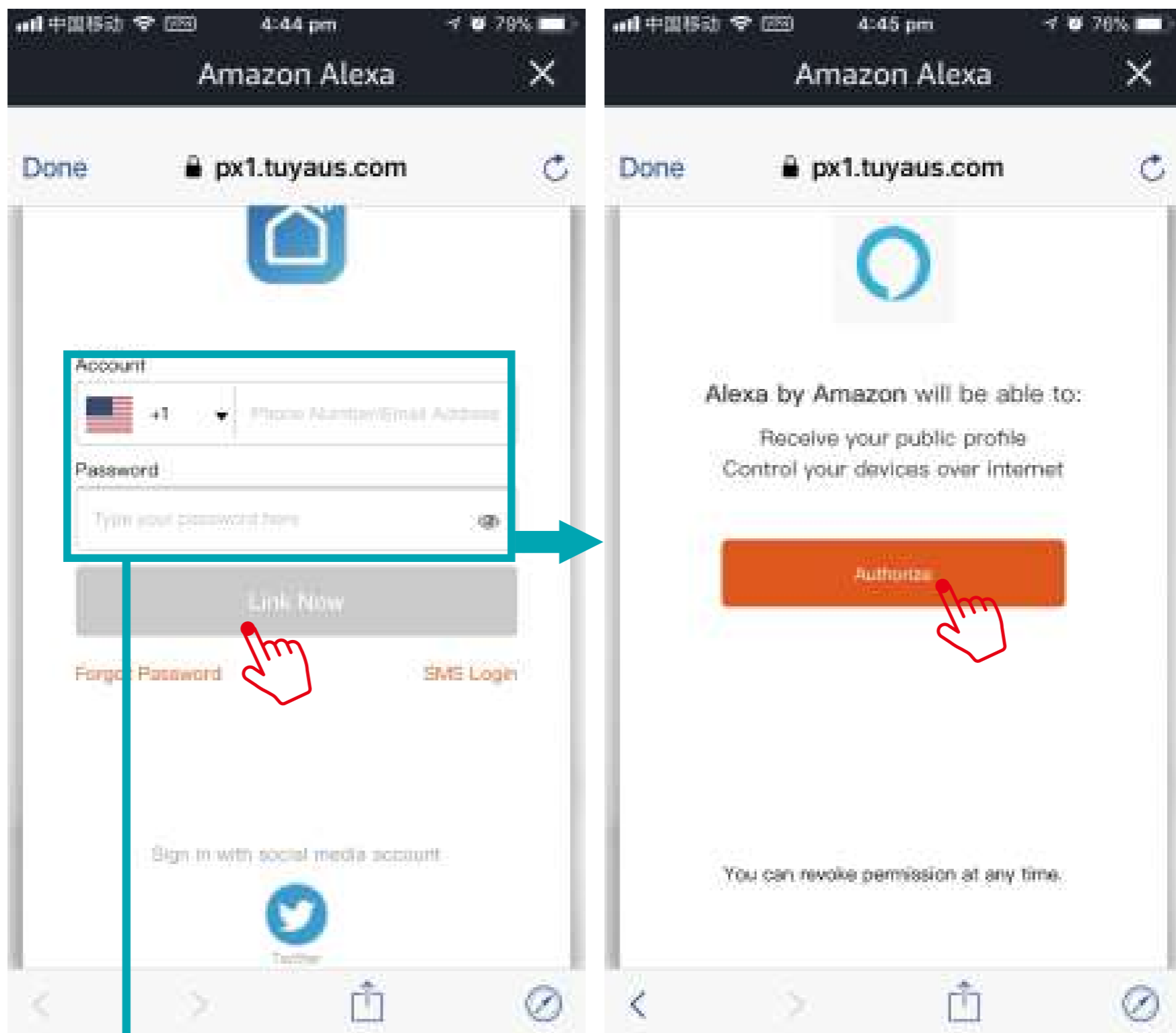

Same account and password as Smart Life App

Step D: Once your Smart Life account is successfully bound to Alexa, the following page will pop up. Tap “Done” on top left corner, then tap “DISCOVER DEVICES” on the next page.

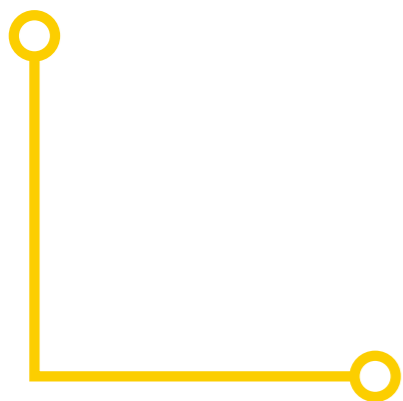
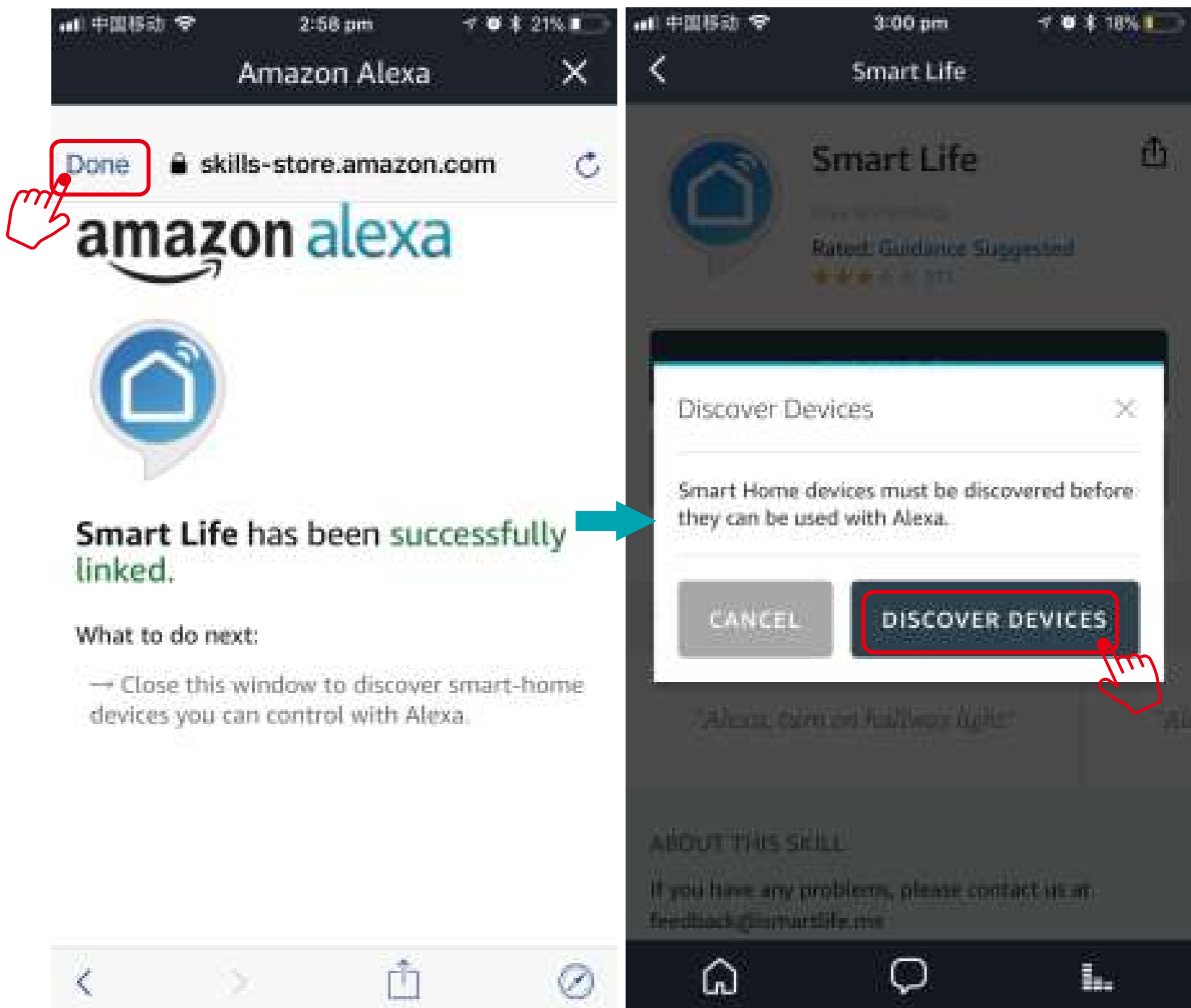

Step E: Wait a few seconds for Alexa to detect the switch from Smart Life app and you will find the device named "Socket" has been paired to Alexa APP from "Smart Life" APP.

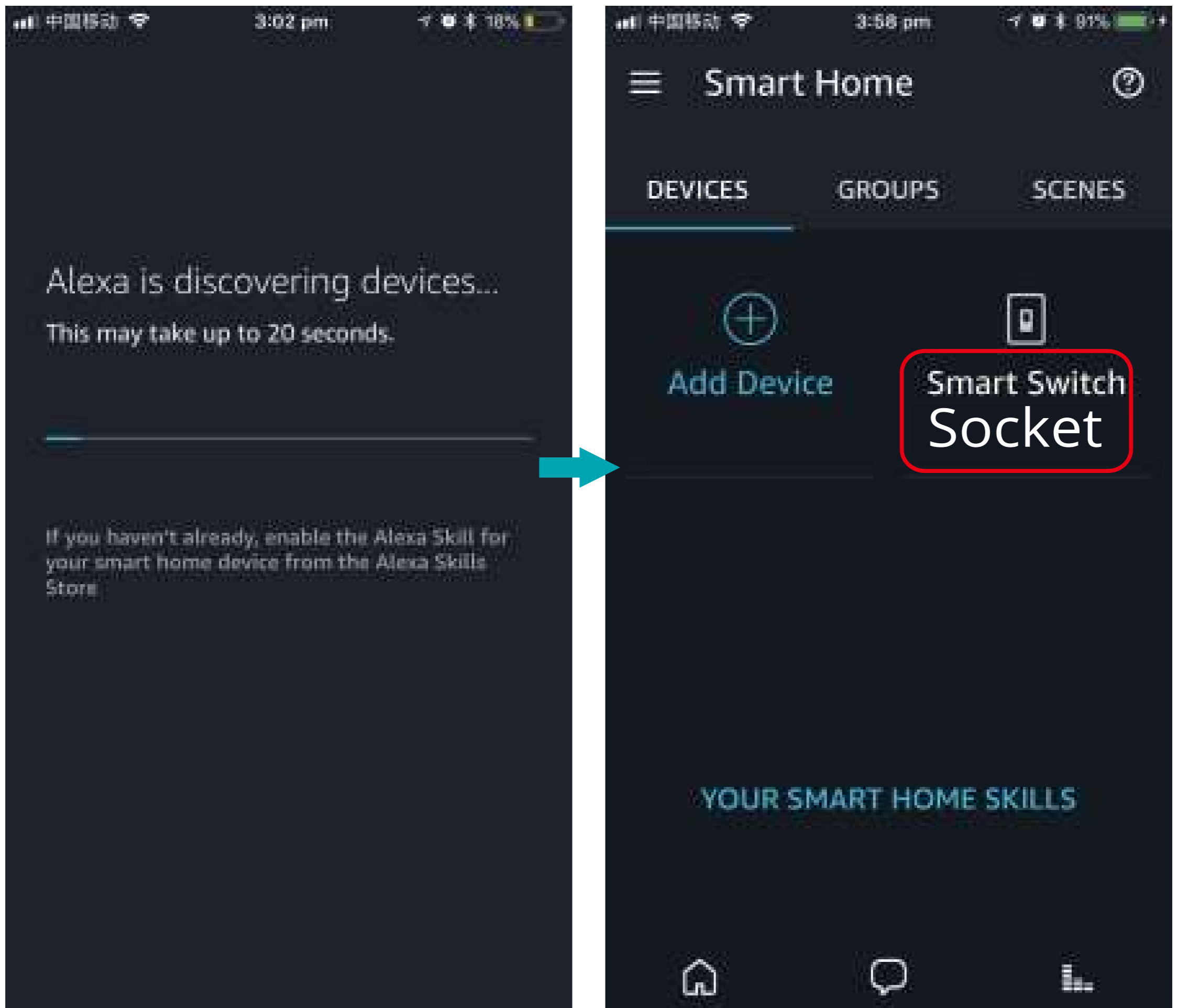

After Step E is done, you can now control the switch with Alexa app on this setting page.

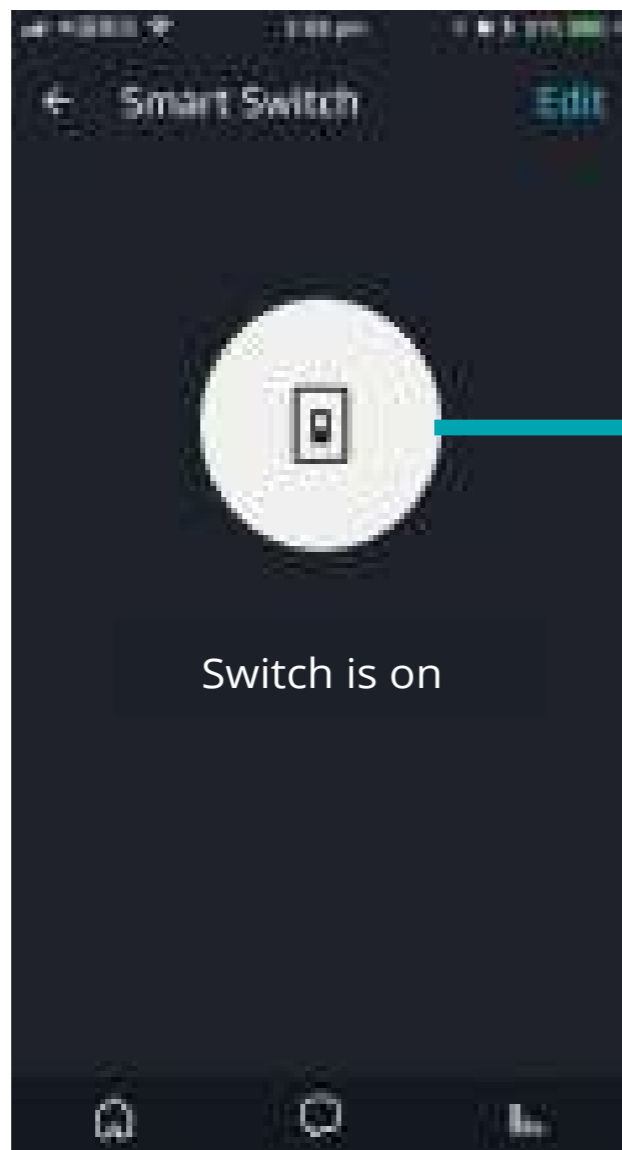

Tap to turn ON/OFF the socket.

Step F: Now you are able to control the socket via Amazon Alexa. Try these commands and see what happens by asking Alexa:

Alexa, turn on "device name"

Alexa, turn off "device name"

Note: The device name is the one you give to the socket on "Smart Life" App. In this user guide, the device is named "Socket".

For example:

"Alexa, turn on Socket",

"Alexa, turn off Socket" etc.

If you also want to control the socket with Google home, you can continue to read next page.

How to control the switch with Google Home?

Preparation:

- Have downloaded the Google Home app
- Have registered your Google Account (only support US account)
- Have paired Smart Socket with Smart life App and named with a simply and easily recognizable name.
- Have finished setting up Google Home

Step A: Open your Google Home APP, tap "Home Control" on the left side bar page.

Step B: Tap "+" button on the button right to enter next page.

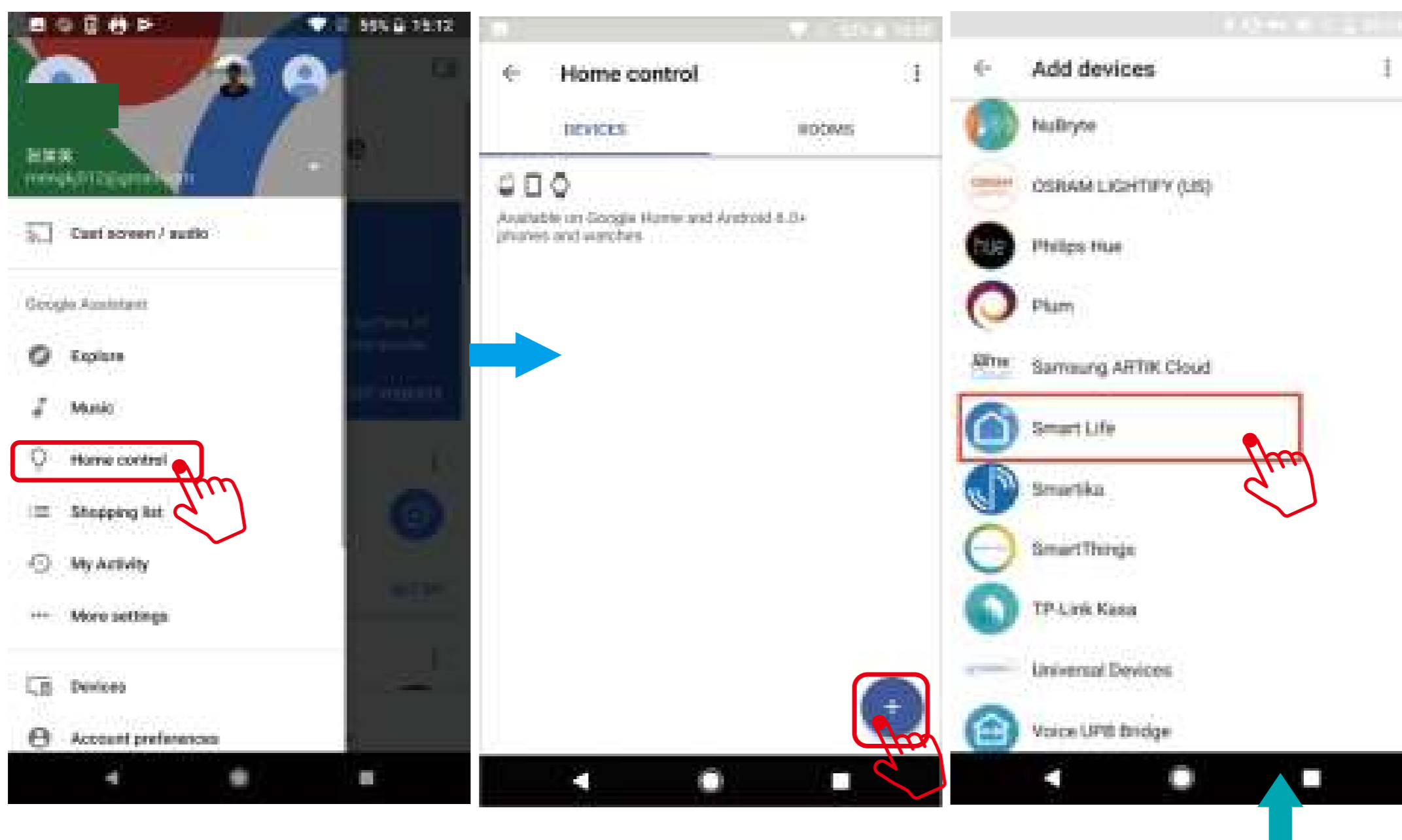

Step C: Find "Smart Life" from the side bar list

Step D: Enter your account and password of “Smart Life” app, tap “Link now”. Then tap “Authorize” on the next page to bind Smart Life account to Google Home.

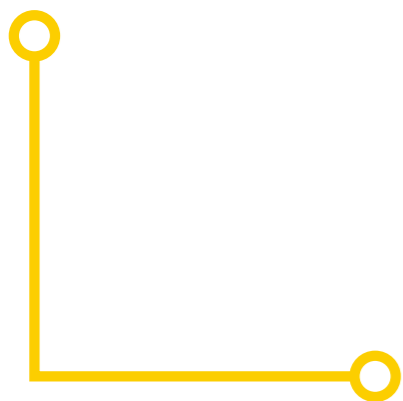
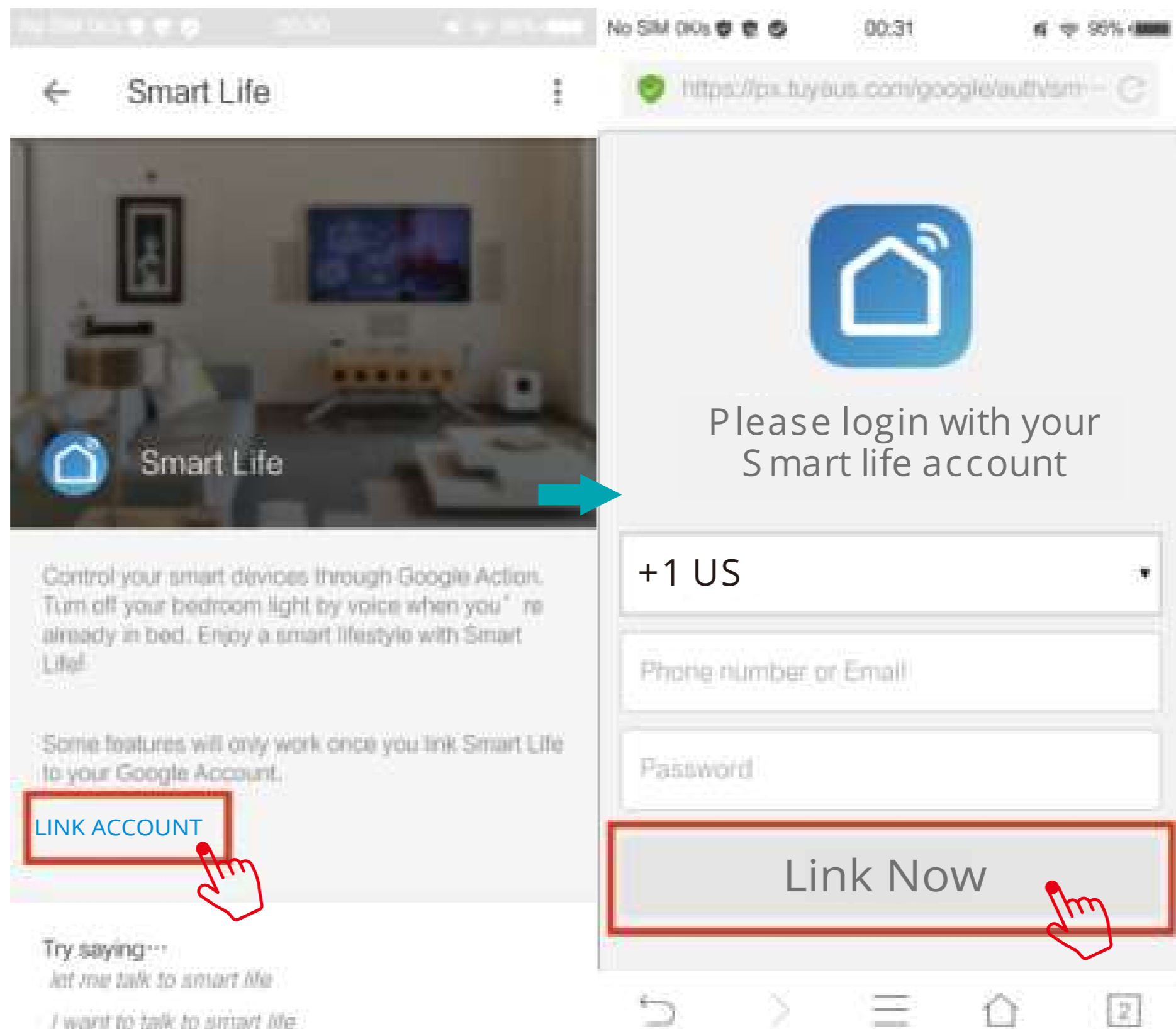

Step E: You will find that Google Home has found the device named "Socket" on this page.

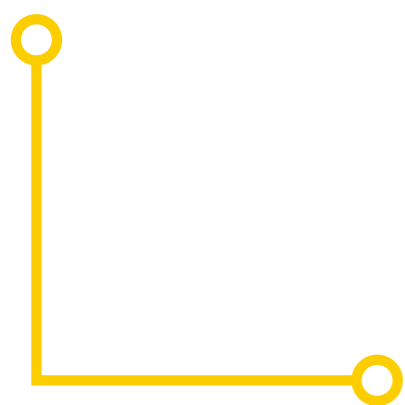
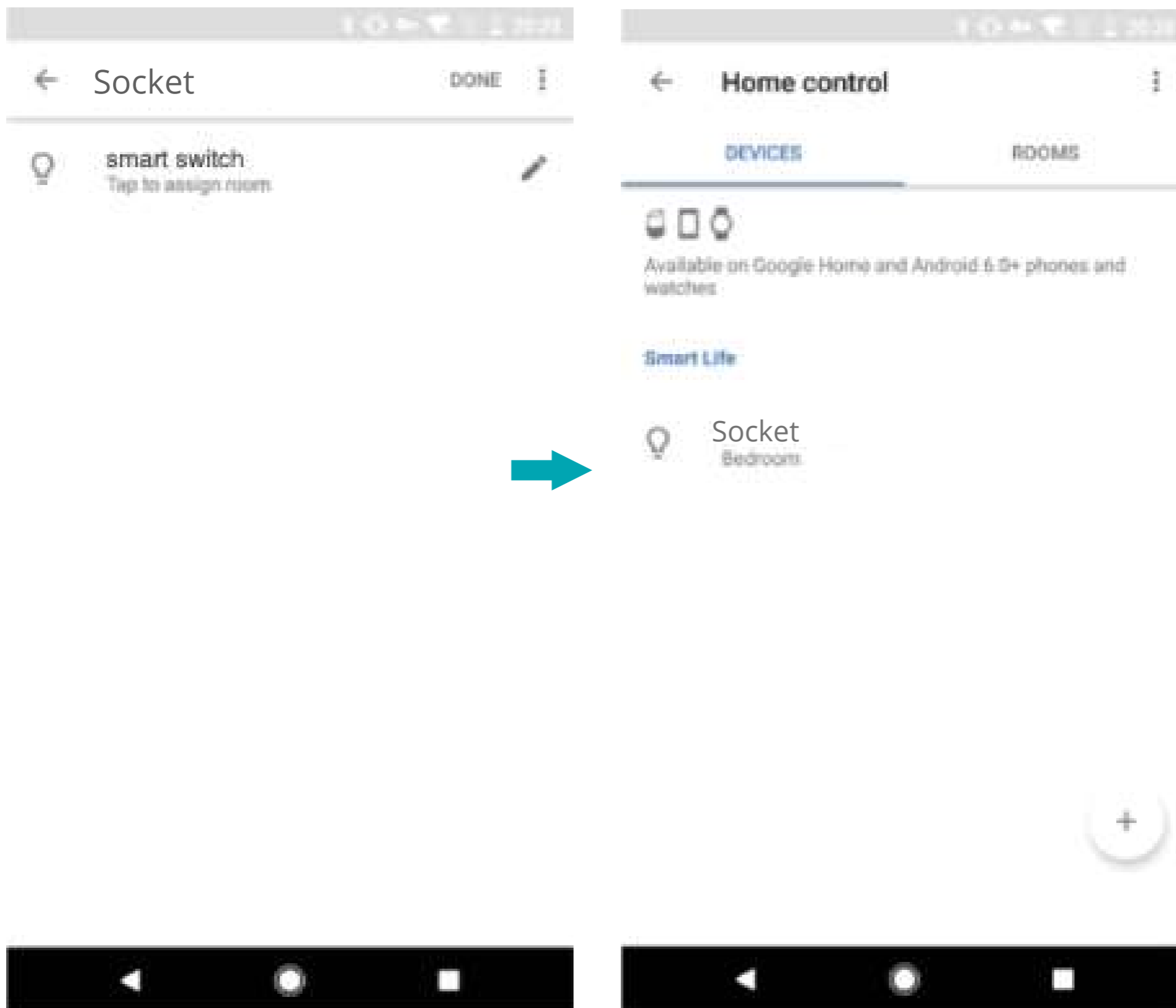

Step F: Now you are able to control the socket via Google Home. Try these commands and see what happens by asking Google

ok, Google, turn on "device name".

ok, Google, turn off "device name".

Note: The device name is the one you give to the switch on "Smart Life" App.

In this user guide, the device is named "Socket".

For example:

"ok, Google, turn on Socket".

"ok, Google, turn off Socket".

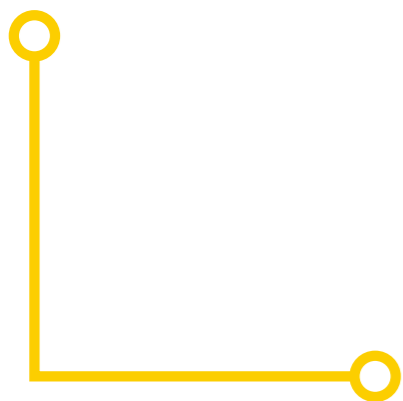

FAQ

Please note when adding device:

1. Confirm device is powered on.
2. Confirm device is waiting for network configuration.
3. Confirm that device, smart phone and router are as close to each other.
4. Make sure the network function of router and smart phone are unblocked.
5. Confirm the entered router password is correct.
6. Confirm added device is under 2.4G Wi-Fi channel.
7. Confirm that router's encryption method is WPA2-PSK and authentication type is AES, or both are set up as automatic.
8. Confirm that Wi-Fi name contains letters only.
9. If router's connected device reach the amount limit. Please try to turn off some devices Wi-Fi function and configure again.
10. If router enables MAC address filter, please try removing the device form MAC filter list and make sure router is allowing device to be connected.

Control device under 2G/3G/4G network?

Device and smart phone must be in the same Wi-Fi environment when adding device. After successful adding, device can be control via mobile network.

How to share my device with family?

Open App, enter into "shared device", tap "add sharing" to share device with family.

How to add device?

Two methods to add device: "Default Mode" and "AP Mode". "Default Mode" is set up as default and can switch to "AP Mode"

Why can't I control the load after installing the product?

1. Please check if the wiring is correct.
2. Please check if there is a neutral line in the cassette (neutral line is required)
3. Please check if the connected load exceeds the maximum value of the device.

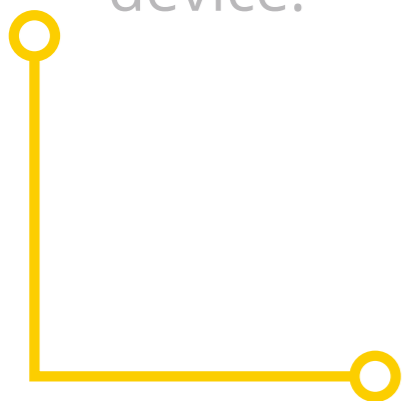

FCC NOTE:

This device complies with Part 15 of the FCC Rules. Operation is subject to the following two conditions:

this device may not cause harmful interference, this device must accept any interference received, including interference that may cause undesired operation. The manufacturer is not responsible for any radio or tv interference caused by unauthorized modifications or change to this equipment. Such modifications or change could void the user's authority to operate the equipment. This equipment has been tested and found to comply with the limits for a Class B digital device, pursuant to part 15 of the FCC Rules. These limits are designed to provide reasonable protection against harmful interference in a residential installation.

This equipment generates, uses and can radiate radio frequency energy and, if not installed and used in accordance with the instructions, may cause harmful interference to radio communications. However, there is no guarantee that interference will not occur in a particular installation. If this equipment does cause harmful interference to radio or television reception, which can be determined by turning the equipment off and on, the user is encouraged to try to correct the interference by one or more of the following measures:

- Reorient or relocate the receiving antenna.
- Increase the separation between the equipment and receiver.
- Connect the equipment into an outlet on a circuit different from that to which the receiver is connected.
- Consult the dealer or an experienced radio/TV technician for help.

RF warning statement:

To maintain compliance with FCC's RF exposure guidelines, this equipment should be installed and operated with a minimum distance of 20cm between the radiator and your body.

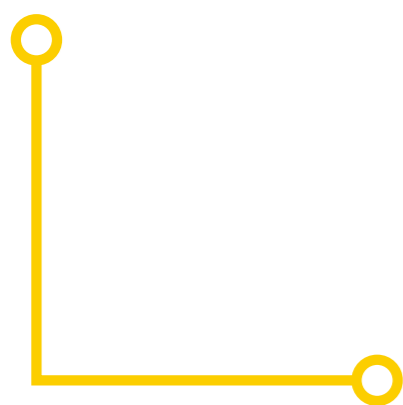



Smart Wall Socket OKS-604S User Manual

www.smartomnia.com

